

# Luminaire For Hazardous Locations

## Installation and Maintenance Manual

### Model THTE1701



Top Hi-Tech Co., Ltd.  
9F, No. 1, Zhongshan Road,  
Tucheng Dist, New Taipei City,  
23680 Taiwan (R.O.C)

Website: [www.tht-ex.com](http://www.tht-ex.com)  
TEL: +886-2-22671234  
FAX: +886-2-22691166  
e-mail: sales@tht-ex.com

Pub. Code:  
Subject to alterations

#### 1. General Information

Model THTE1701 LED Luminaires are suitable for use in the following hazardous (classified) areas as defined by the National Electrical Code (NEC) and Canadian Electrical Code (CEC):

- Class I, Division 1, Groups B, C, D
- Class II, Division 1, Groups E, F, G
- Class III, Division 1
- Wet Locations

Refer to the luminaire nameplate for specific classification information, maximum ambient temperature suitability and corresponding operating temperature (T-Code).

Model THTE1701 LED Luminaire is designed for using in indoors and outdoors environment.

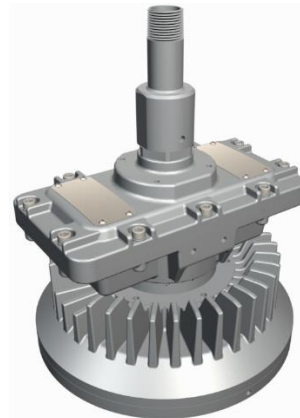

Rated Voltage: 120~277 Vac, 50 & 60 Hz  
Rated Wattage: 60W /80W /100W  
Ambient Temperature Range: -40°C ~ +40°C

#### WARNING

- ▶ To avoid the risk of fire, explosion or electric shock, this product should be installed, inspected and maintained by a qualified electrician only, in accordance with all applicable codes and regulations.
- ▶ To avoid electric shock:
  - ✓ Be certain electrical power is OFF before and during installation and maintenance.
  - ✓ Luminaire must be supplied by a wiring system with an equipment grounding conductor suitable for the specific hazardous locations in accordance with the NEC and CEC.
- ▶ To avoid explosion:
  - ✓ Make sure that the supply voltage is the same as the luminaire voltage.
  - ✓ Do not install where the marked operating temperatures exceed the ignition temperature of the hazardous atmosphere.
  - ✓ Do not operate in ambient temperatures above those indicated on the luminaire nameplate.
  - ✓ All O-rings and gasket seals must be clean and undamaged.
  - ✓ Before installation and dismantling, electrical power to the luminaire must be turned off. Keep tightly closed when in operation.
- ▶ To avoid burning hands, ensure the luminaire is cool when performing maintenance.

#### 2. Dimensions (All Dimensions in mm) –

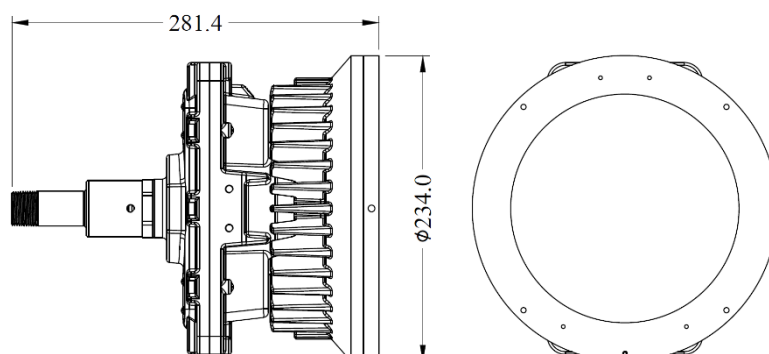

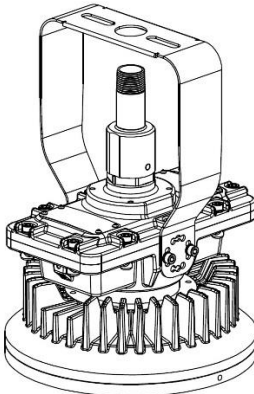
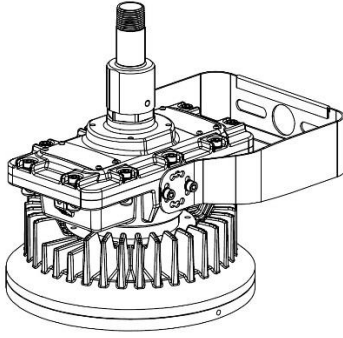

### 3. Technical Data

Item	Description	
Rated Voltage	120 Vac~277 Vac, 50 & 60 Hz (Note information on type label)	
Wattage	60W / 80W / 100W	
Color of LED light	3000K $\pm$ 10% (Warm White) / 5000K $\pm$ 10% (Cool White)	
CRI	> 80	
Power Factor	$\cos \phi \geq 0.9$	
Ambient Temperate Range	-40°C ~ +40°C	
Material Enclosure Glass	Aluminum alloy Heat and impact resistant tempered glass	
LED Service Life	60,000 hrs	
Mounting Type / Weight	Two-position (wall/ceiling) adjustable trunnion, each position with two aiming angles (25° and 90° adjustable)	
		
	8.6 kg	8.6 kg

### 4. Assembly and Installation

#### 4.1 Electrical Connection

##### Overview of Nipple Assembly

1: Power Box Cover	2: Nipple Body Gasket	3: Nipple Body	4: M4 Screw	5: Adapter
--------------------	-----------------------	----------------	-------------	------------

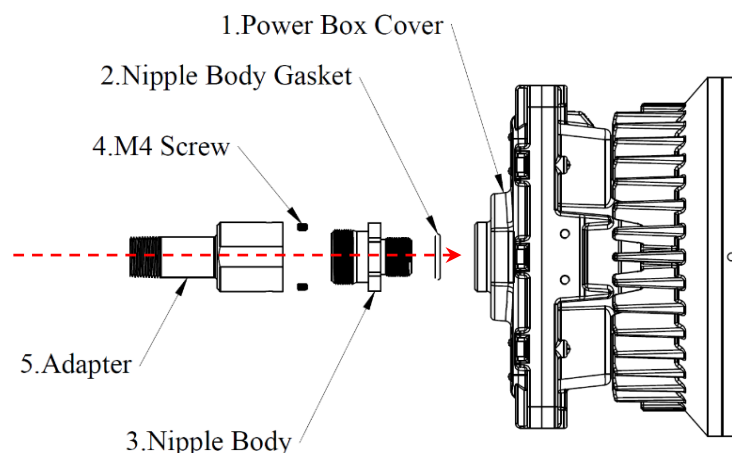

The Top Cover is equipped with the adapter (5) with 3/4 in. NPT external threads for supply connections.

## Overview of Electrical Connection

1: Model THTE1701 Luminaire	2: Leads (Length: min, 18 inches)	3: Adapter
-----------------------------	-----------------------------------	------------

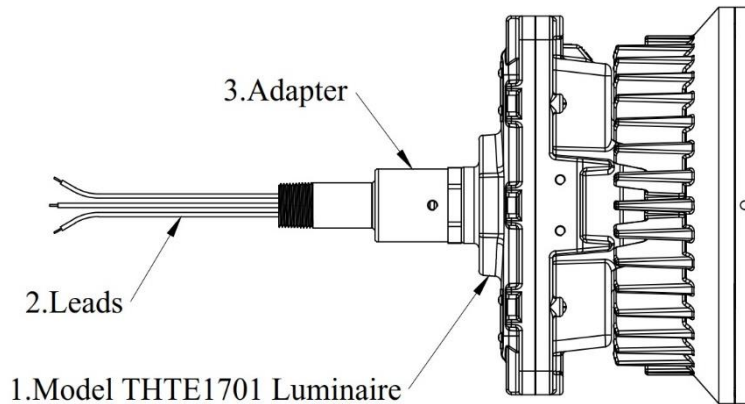

1. Insert the field wiring leads (2) through the conduit (not shown, provided in the field).
2. Connect conduit to 3/4 in, NPT external threads of adapter with at least five full threads engaging.
3. Connect branch conduit wires to luminaire wiring necessary raceway component, boxes and fitting required per NEC and CEC. (White-wire connects to Neutral; Red-wire connects to Live; Green-wire connects to Ground.)

## 4.2 Mounting Bracket Installation

### 4.2.1 Two Position (wall/ceiling) Adjustable Trunnion Mounting Bracket

- ☞ The mounting bracket is for the use of wall and ceiling mounting.
- ☞ Position the bracket holders and secured to mounting surface by means of the provided M6 screws with torque value 24.5 kgf-cm. (Figures 1 and 2)
- ☞ Secure the wall mounting bracket to the structure by using four fasteners (not provided).(Figure 3)
- ☞ The lighting can be adjusted by 25° (Lens facing down 25° from vertical) or 90° (Lens facing down 90° from vertical). (Figure 4)

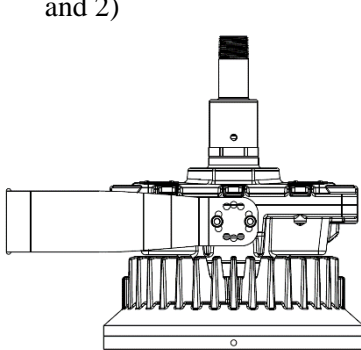

Figure 1

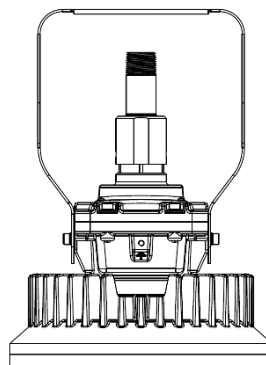

Figure 2

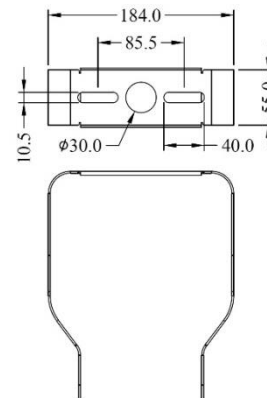
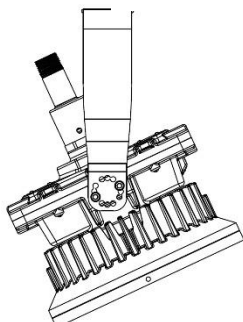
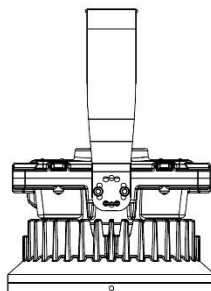

Figure 3



Ceiling 25°



Ceiling 90°

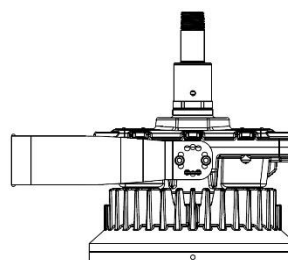

Wall 90°

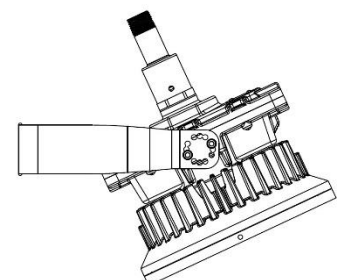

Wall 25°

Figure 4



### 4.3 Putting into Service

Before putting into operating, it's necessary to ensure that:

- ☞ the lighting is correctly installed.
- ☞ the connection has been correctly made.
- ☞ the field wiring has been made per NEC and CEC requirement.

## 5. Maintenance

---

- ▶ To avoid personal injury, disconnect power to the light and allow the unit to cool down before performing maintenance.
- ▶ Perform visual, electrical, and mechanical inspections on a regular basis. The environment and frequency of use should determine this. However, it is recommended that checks be made at least once a year. Frequency of use and environment should determine this. It is recommended to follow an Electrical Preventive Maintenance Program as described in the National Fire Protection Association Bulletin NFPA No. 70B: Recommended Practice for Electrical Equipment Maintenance.
- ▶ The lens should be cleaned periodically to ensure continued lighting performance. Clean the lens with a clean, damp, non-abrasive, lint-free cloth. If this is not sufficient, use a mild soap or a liquid cleaner. Do not use an abrasive, strong alkaline or acid cleaner as damage may occur.
- ▶ Inspect the cooling fins on the luminaire to ensure that they are free of any contamination (i.e. excessive dust build-up). Clean with a non-abrasive cloth if needed.
- ▶ Electrically check to make sure that all connections are clean and tight.
- ▶ Mechanically check that all parts are properly assembled.

## 6. Transport, Storage and Disposal

---

- ▶ Transport and storage is only allowed in the original packaging, on the way pointed out on the carton box.
- ▶ Transport – Shock-free in its original carton, do not drop, and handle carefully.
- ▶ Store – Store in a dry place in its original packaging.
- ▶ Disposal – Ensure environmentally friendly disposal of all components according to the legal regulations.