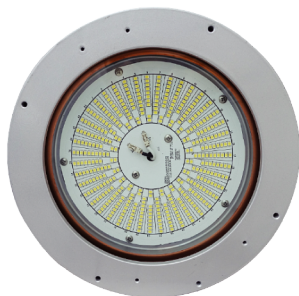

L1701

Universal
Explosion-proof LED Lighting

Net Weight: 8.0 kg (17.6 lb)

Zone
1

Zone
2

Zone
21

Zone
22

IP67

NEMA
6

Protection

- Ex db IIC T5 Gb
- Ex tb IIIC T95°C Db
- Ex db IIC T6 Gb
- Ex tb IIIC T80°C Db

Standards

IEC 60079-0
IEC 60079-1
IEC 60079-31

Light Features

- Full Voltage Explosion-proof LED Lighting for Zone 1
- Salt spray 1000 hrs passed
- Service life up to 60,000 hours

Technical Data

Rated Voltage (±10%)	100V ~ 277V AC (Full Voltage)			
Watts (±10%)	60W / 80W / 100W			
Amps	60W: 0.21 ~ 0.60A / 80W: 0.28 ~ 0.80A / 100W: 0.36 ~ 1.00A			
Color of LED Light	3000K (Warm White) / 5000K (Cool White)			
Ambient Temperature	-20°C ~ +50°C, T5 / -20°C ~ +40°C, T6			
Power Factor	cos ≥ 0.9			
CRI	Cool White ≥ 70 / Warm White ≥ 80			
Lumen (±10%)	SMD	60W	80W	100W
	3000K	6000lm	8000lm	10000lm
	5000K	6600lm	8800lm	11000lm
Beam Angle	X-110° / Y-110°			
Frequency	50 / 60 Hz			
Degree of Protection	IP67 / NEMA 6			
Material: Enclosure	Aluminum alloy			
LED Service Life	60,000 hrs			
Entrance Thread	1 × M25			

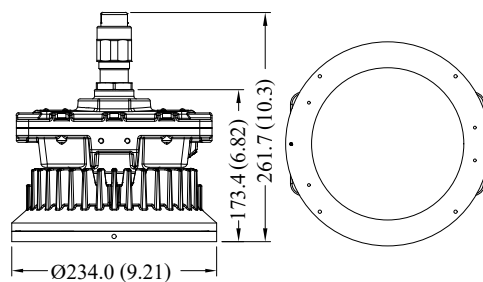

Dimension in Millimeters (inches)

Optical Report

Polar Luminous
Intensity Distribution

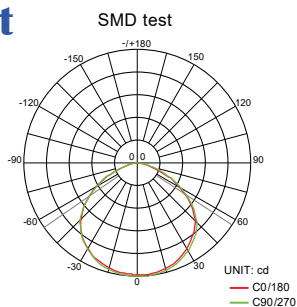

Luminous
Intensity Distribution Diagram

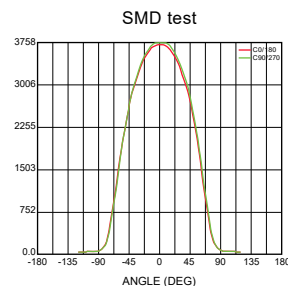

Model Code

THT	E	1701	A	C	K	C	A	J0	S25
Brand, THT=TOP HI-TECH CO., LTD.	Protection type of luminaire, E=Explosion proof luminaires	Model Name, 1701=Model L1701	Sub-series designation	Type of top cover, C=Top cover with opening	Type of LED model, K=SMD LED Module	C.C.T., C=Cool White, W=Warm White	Voltage, A=100 ~ 277V	Wattage, F0=60W, H0=80W, J0=100W	Mounting bracket type S25/90=Bending Electrical Tube 25°/90° P90=Straight Electrical Tube WHT(W90)=Wall Mount 90° WHT(H90)=Hanging Mount 90°

Mounting Option & Dimensions (All in mm)

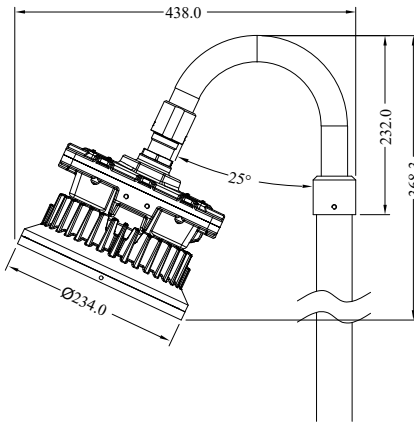
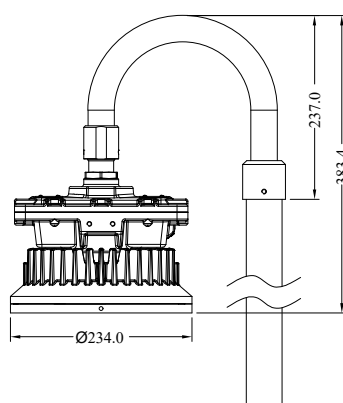
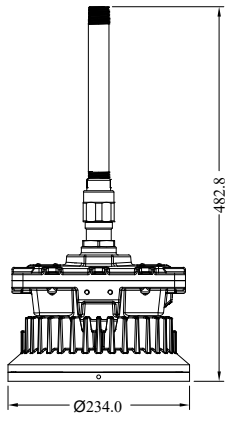
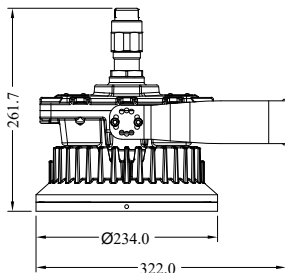
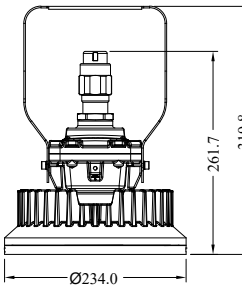
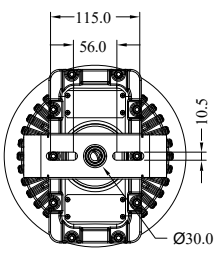
<p>Bending Electrical Tube 25° (S25)</p>  <p>9.4 kg (20.7 lb)</p>	<p>Bending Electrical Tube 90° (S90)</p>  <p>9.5 kg (20.9 lb)</p>	<p>Straight Electrical Tube (P90)</p>  <p>8.5 kg (18.7 lb)</p>
<p>Wall Mount 90° [WHT (W90)]</p>  <p>8.6 kg (18.9 lb)</p>	<p>Hanging Mount 90° [WHT (H90)]</p>  <p>8.6 kg (18.9 lb)</p>	

Applicable Area

- Oil Refinery Complex
- Painting Facility
- Transproting Liquefied
- Offshore Platform
- Petrochemical Complex
- Transporting Nature Gas
- Petroleum Gas
- (Oil and Natural Gas)