

HazLoc LED LUMINAIRE

Installation and Maintenance Manual

HazLoc Model L1908 Series



Top Hi-Tech Co., Ltd.
9F, No.1, Zhongshan Road, Tucheng
Dist. New Taipei City, 23680,236
Taiwan

Website: www.tht-ex.com
TEL: +886 2 2267-1234
FAX: +886 2 2269-1166
e-mail: sales@tht-ex.com

Pub. Code:A0
Subject to alterations

1. General Information:

Model L1908 LED Luminaires are suitable for use in the following hazardous (classified) areas as defined by the National Electrical Code (NEC) and Canadian Electrical Code (CEC):

- Class I, Division 2, Groups A, B, C, D
- Class II, Division 2, Groups F, G

Wet Locations (UL 1598)

Refer to the luminaire nameplate for specific classification information, maximum ambient temperature suitability and corresponding operating temperature (T-Code). Model L1908 LED Luminaire is designed for using in indoors and outdoors environment. Ambient Temperate Range: -40°C ~ +50°C and -40°C ~ +60°C



WARNING

- To avoid the risk of fire, explosion or electric shock, this product should be installed, inspected and maintained by a qualified electrician only, in accordance with all applicable codes and regulations.
- To avoid electric shock:
 - ✓ Be certain electrical power is OFF before and during installation and maintenance.
 - ✓ Luminaire must be supplied by a wiring system with an equipment grounding conductor.
- To avoid explosion:
 - ✓ Make sure that the supply voltage is the same as the luminaire voltage.
 - ✓ Do not install where the marked operating temperatures exceed the ignition temperature of the hazardous atmosphere.
 - ✓ Do not operate in ambient temperatures above those indicated on the luminaire nameplate.
 - ✓ All gasket seals must be clean and undamaged.
 - ✓ Use proper supply wiring as specified on the luminaire nameplate.
 - ✓ Before dismounting, electrical power to the luminaire must be turned off. Keep tightly closed when in operation.
- To avoid burning hands, ensure the luminaire is cool when performing maintenance.

2. Dimensions (All Dimensions in mm) – Subject to Alterations:

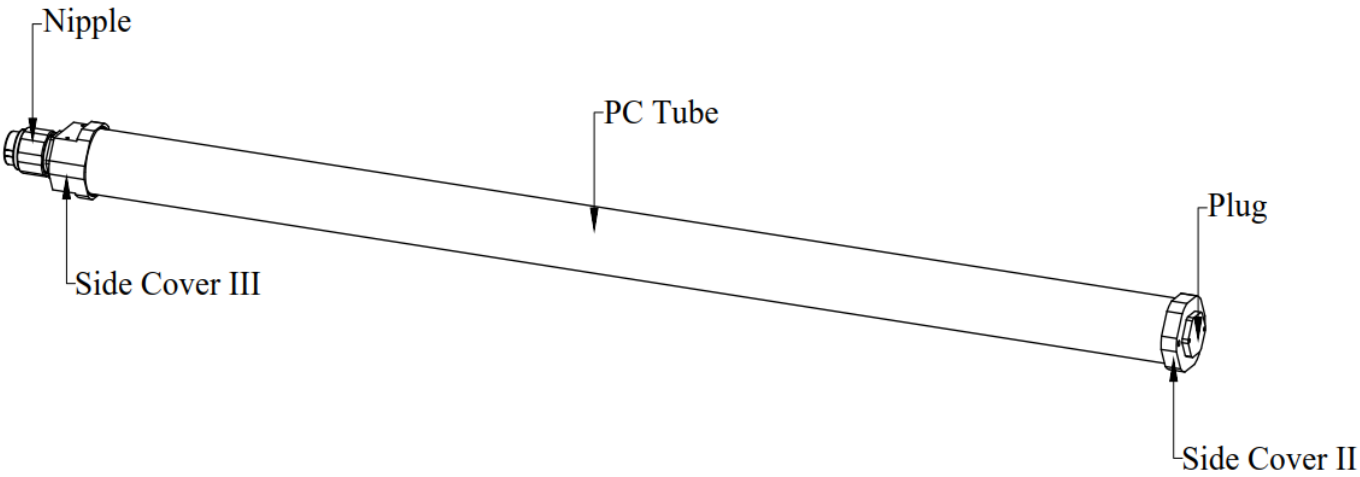

Item	A(mm)
Short	411
Middle	661
Long	1161

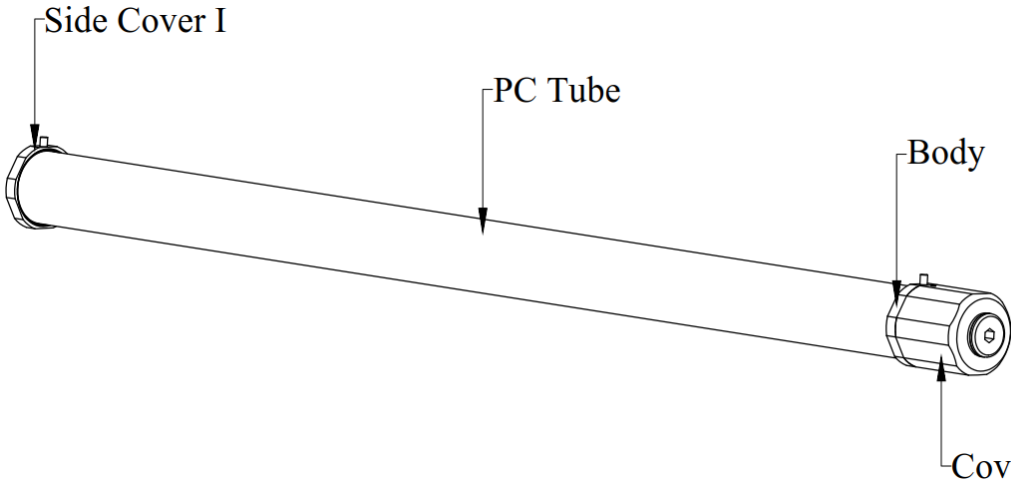
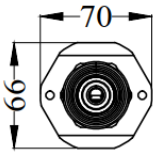
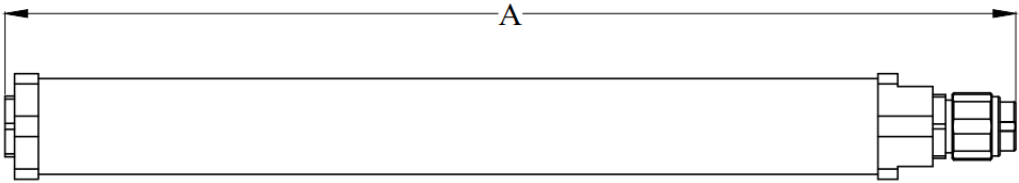

Item	B(mm)
Short	401
Middle	651
Long	1151

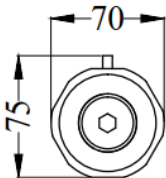
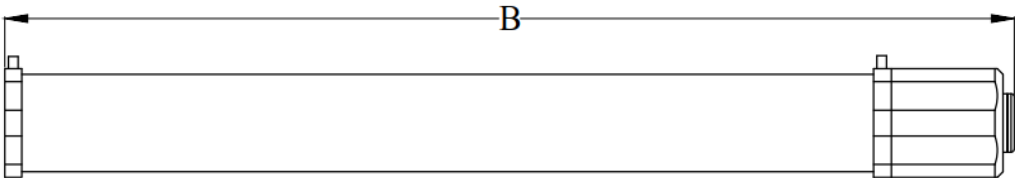

3. Technical Data:

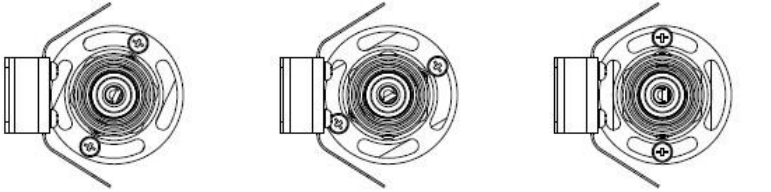
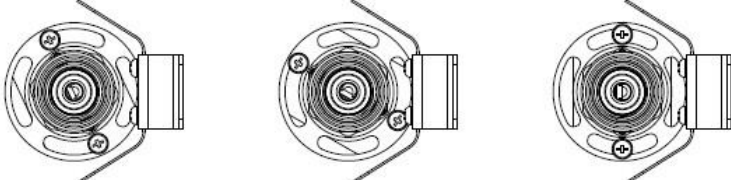
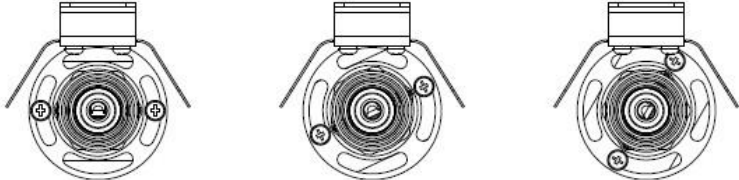
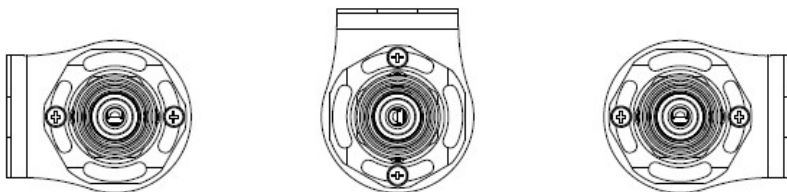
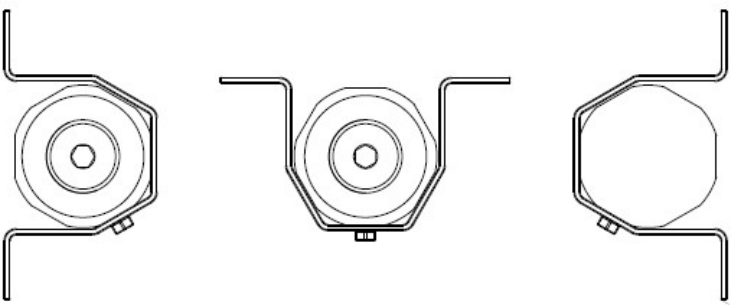
Item	Description
Rated Voltage	120/ 220/ 277/ 347/ 480 Vac, 50 & 60 Hz (Note information on type label)
Power Factor	$\cos \varphi \geq 0.9$
Ambient Temperate Range	-40°C ~ +50°C and -40°C ~ +60°C
Material	
Enclosure	Aluminum alloy
Illuminate Enclosure	Polycarbonate
LED Service Life	60,000 hrs
Mounting Type	WHT Mounting
	With Reflector
	
	
	
	Without Reflector
	
	

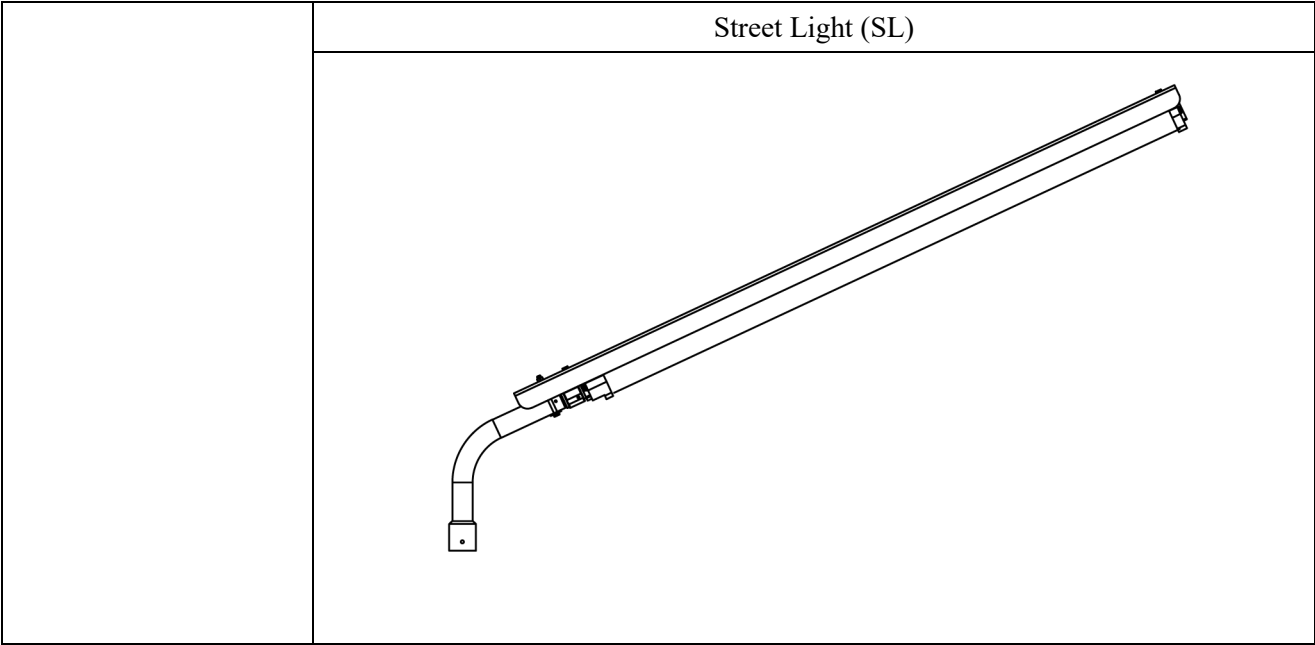

4. Assembly and Installation:

4.1 Electrical Connection:

4.1.1 With Nipple:
(Overview of Connection Base)

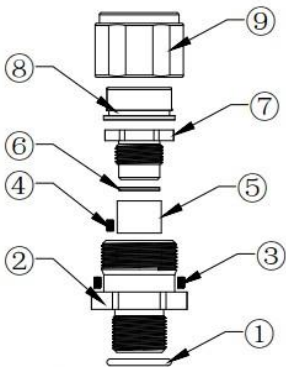

1. Nipple Body Gasket	4. M4 Socket Set Screws	7. Pressure Nut
2. Nipple Body	5. Tube	8. Connector
3. M4 Socket Set Screws	6. Washer	9. Sleeve

(Overview of Electrical Connection) :

1	L1908 Type Luminaire
2	Wire (Length: Min 24 inches)
3	Junction Box (Provide by Customer)

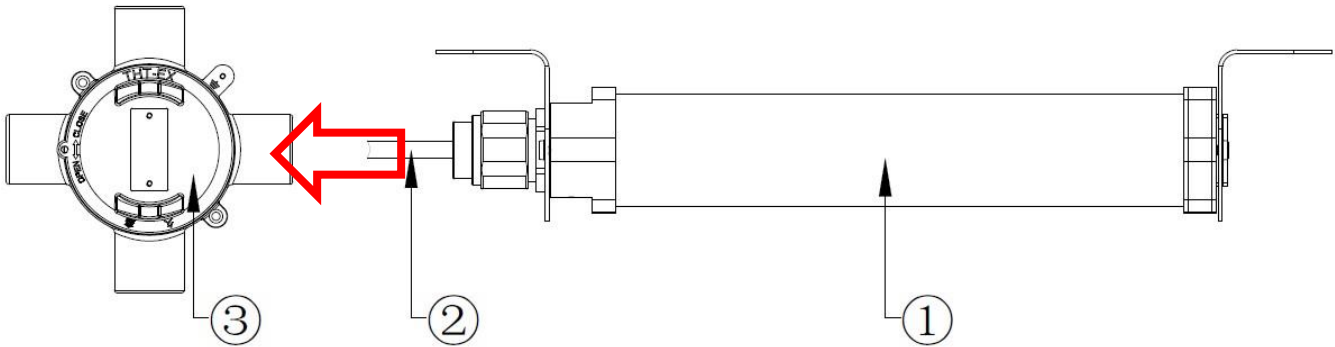

4.1.1.1. For "WHT" mounting: Insert the wires (2) through the conduit (not shown, provide in the field) into the Junction Box (3) (provide in the field).

- 4.1.1.2. For "Street Light" mounting: Insert the wires (2) through the integral mounting bracket and then through the conduit (not shown, provide in the field) into the Junction Box (provide in the field).
- 4.1.1.3. Fix and Introduce the wires of luminary with the terminal post of Junction Box (White-wire connects to Neutral; Red-wire connects to Live; Green-wire connects to Ground.)

4.1.2 Without Nipple (Overview of Electrical Connection):

- 4.1.2.1. First open the side cover and the input power wire through into the side cover. (Note: Side cover must connector for conduit (provide in the field) or seal fitting (provide in the field) , Follow National Electrical Code)
- 4.1.2.2. And then the input wire is connected to the output wire (White-wire connects to Neutral; Black-wire connects to Live; Green-wire connects to Ground)
- 4.1.2.3. The side cover and lamp body are screwed into and touch each other, and then the socket set screws are locked.

4.2 Mounting Bracket Installation:

4.2.1 Two position Adjustable Trunnion (Wall & Ceiling) Mounting(WHT) - each position with four aiming angle(0 degree 、 25 degree 、 60 degree 、 90 degree) - Secured to wall/ceiling surface (The projection angle of the lamp can be adjusted according to the angle set by the bracket)

- The mount bracket is for the use of both Wall mount (Figure 1) and Ceiling mount (Figure 2).
- Position the bracket holders and fix it by screws.(not provided screws)
- Secure the Wall/Ceiling mounting bracket to the structure by using four fasteners (not provided).
- The angle of lighting fixture can be adjusted.

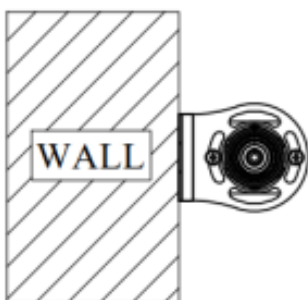

Figure 1

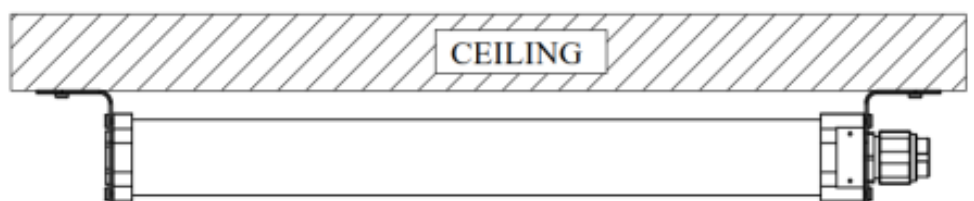
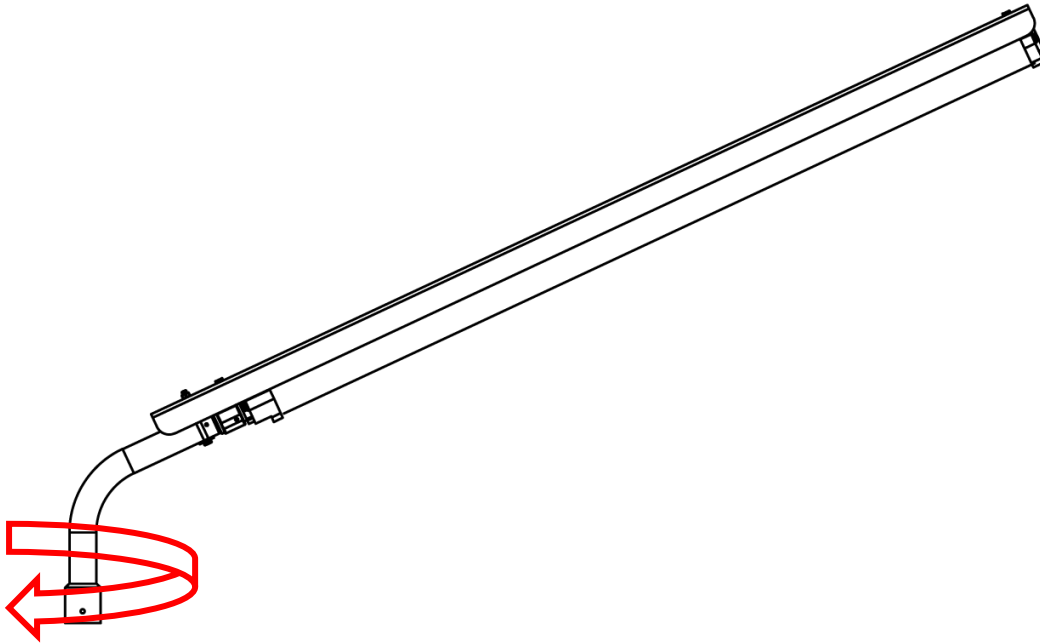

Figure 2

4.2.2 Street Light (SL)

- Elbow through the pipe clip fixing the lamp cable gland sleeve, and then Stanchion tube into pillar fix

M6 set screws.



4.3 Putting into Service:

Before putting into operating, it's necessary to ensure that:

- ☞ The lighting is correctly installed.
- ☞ The connection has been correctly made.
- ☞ The voltage is correctly.
- ☞ The field wiring has been inserted correctly.

5. Maintenance:

- To avoid personal injury, disconnect power to the light and allow the unit to cool down before performing maintenance.
- Perform visual, electrical, and mechanical inspections on a regular basis. The environment and frequency of use should determine this. However, it is recommended that checks be made at least once a year. Frequency of use and environment should determine this. It is recommended to follow an Electrical Preventive Maintenance Program as described in the National Fire Protection Association Bulletin NFPA No. 70B: Recommended Practice for Electrical Equipment Maintenance.
- The lens should be cleaned periodically to ensure continued lighting performance. Clean the lens with a clean, damp, non-abrasive, lint-free cloth. If this is not sufficient, use a mild soap or a liquid cleaner. Do not use an abrasive, strong alkaline or acid cleaner as damage may occur.
- Inspect the cooling fins on the luminaire to ensure that they are free of any contamination (i.e. excessive dust build-up). Clean with a non-abrasive cloth if needed.
- Electrically check to make sure that all connections are clean and tight.
- Mechanically check that all parts are properly assembled.

6. Transport, Storage and Disposal:

- Transport and storage is only allowed in the original packaging, on the way pointed out on the carton box.
- Transport – Shock-free in its original carton, do not drop, and handle carefully.
- Store – Store in a dry place in its original packaging.
- Disposal – Ensure environmentally friendly disposal of all components according to the legal regulations.