

L2101

Luminaires For Use In Hazardous Locations

2ft-Dual Tubes



4ft-Dual Tubes



4ft-Single Tube



Protection

- Class I, Division 1 Group C, D
- Class II, Division 1 Group E, F, G
- Class III

Standards

UL 844
UL 1598 Luminaires
CSA C22.2 No. 137-18
CSA C22.2 No. 250.0

Net Weight:
2ft-Single Tube: 5.0kg (11.0 lb) / 4ft-Single Tube: 7.7kg (16.9 lb)
2ft-Dual Tube: 7.3kg (16.1 lb) / 4ft-Dual Tube: 10.4kg (22.8 lb)

4ft- Dual Yellow Tubes



Technical Data

Explosion-proof LED Tube				
Size	2ft-Single Tube	4ft-Single Tube	2ft-Dual Tubes	4ft-Dual Tubes
Watt.(±10%)	9W	18W	18W	36W
Volt.(±10%)	100V-277V AC			
Light Color	Warm White (3000K) / Natural White (4000K) / Daylight (5000K) / Cool White (6500K)			
Lm / W (±10%)	≥100lm			

Yellow Tube Light				
Size	2ft-Single Tube	4ft-Single Tube	2ft-Dual Tubes	4ft-Dual Tubes
Watt.(±10%)	10W	20W	20W	40W
Volt.(±10%)	120V-277V AC			
Light Color	Yellow			

Amps	9W: 0.03A~0.09A, 10W: 0.04A~0.08A, 18W: 0.06A~0.18A, 20W: 0.07A~0.20A, 36W: 0.13A~0.36A, 40W: 0.14A~0.33A	
Ambient Temperature	-20°C ~ +40°C, T6	
Power Factor	cos≥0.9	
CRI	≥70 (Excluding Yellow Tube)	
Beam Angle	X-110° / Y-110°	
Frequency	50 / 60 Hz	
Degree of Protection	IP67 / NEMA 6	
Material	<div><div>• Enclosure</div><div>• Lighting Tube</div></div>	Aluminum Alloy Glass
LED Service Life	60,000 hrs	
Entrance Thread	1 x M25	

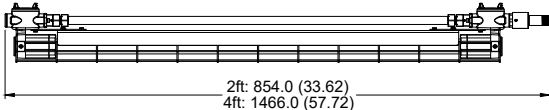

2ft: 854.0 (33.62)
4ft: 1466.0 (57.72)

Single Tube

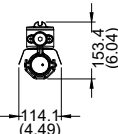

153.4
(6.04)
114.1
(4.49)

Dual Tubes

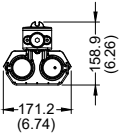

158.9
(6.26)
171.2
(6.74)

Dimension in Millimeters (inches)

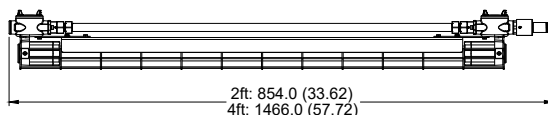

Single Tube

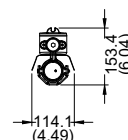

Dual Tubes

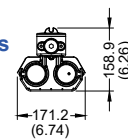

Dimension in Millimeters (inches)

Optical Report

Polar Luminous
Intensity Distribution

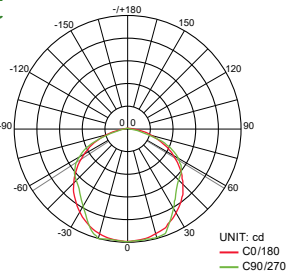

Luminous
Intensity Distribution Diagram

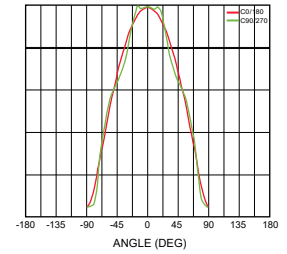

Yellow Light - Spectral Distribution

Relative Spectral

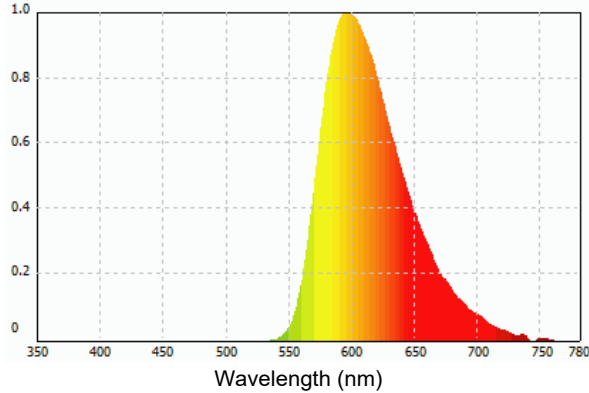

Mounting Option & Dimensions (All in mm)

Single Tube

Ceiling (C90) / Wall Mount 90° (W90)

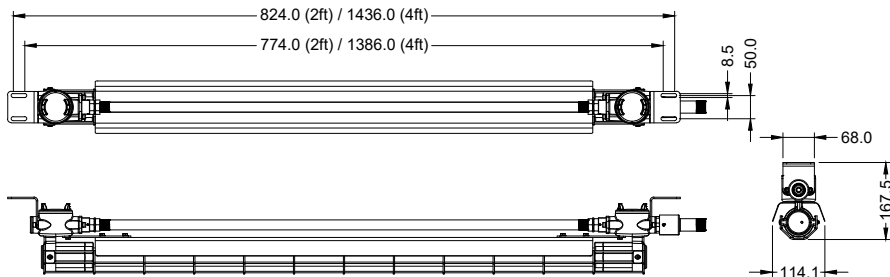

2ft-Single Tube:5.4kg (11.9 lb)
4ft-Single Tube:8.1kg (17.9 lb)

Pendant Mount (P90)

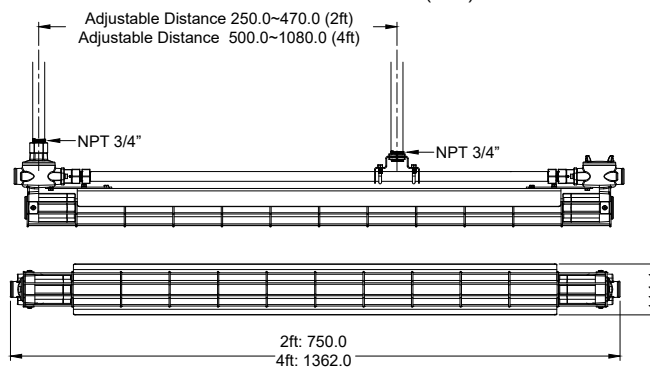

2ft-Single Tube:5.3kg (11.7 lb)
4ft-Single Tube:8.0kg (17.6 lb)

(The pendant mount doesn't include electrical tubes, but with installation holes reserved.)

Mounting Option & Dimensions (All in mm)

Dual Tubes

Ceiling (C90) / Wall Mount 90° (W90)

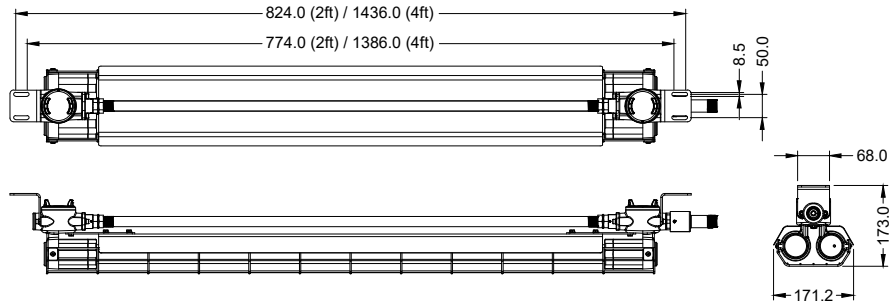

2ft-Dual Tube: 7.7kg (17.0 lb)
4ft-Dual Tube: 10.8kg (23.8 lb)

Pendant Mount (P90)

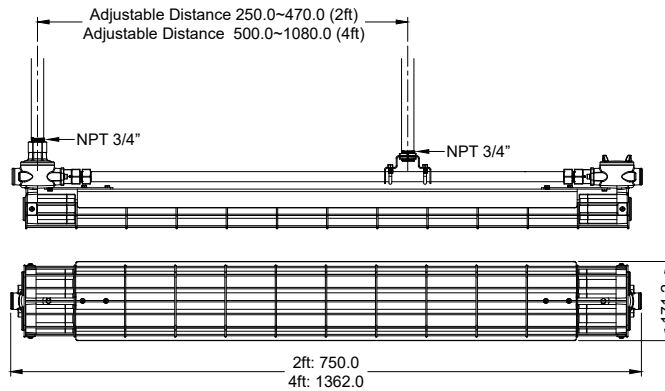

2ft-Dual Tube: 7.6kg (16.8 lb)
4ft-Dual Tube: 10.7kg (23.6 lb)

(The pendant mount doesn't include electrical tubes, but with installation holes reserved.)

Model Code

THT

E

2101

D

D

W

H

C6

C90

①

②

③

④

⑤

⑥

① Length of Luminaire

A=2ft single tube (For 9W, 10W only)
B=4ft single tube (For 18W, 20W only)
C=2ft double tubes (For 18W, 20W only)
D=4ft double tubes (For 36W, 40W only)

③ Light Color

W=Warm white/3000K (For 9W, 18W or 36W only)
N=Natural white/4000K (For 9W, 18W or 36W only)
D=Daylight/5000K (For 9W, 18W or 36W only)
C=Cool white/6500K (For 9W, 18W or 36W only)
Y=Yellow tube (For 10W, 20W or 40W only)

⑥ Mounting Bracket Type

C90=Ceiling
W90=Wall Mount 90°
P90=Pendant

② Type of Top Cover

C=Top cover with opening
D=Top cover without opening

*Pendant Mount only with C type
(top cover with opening).

④ Voltage

A=120-277V (For 10W, 20W, 30W)
H=100-277V (For 9W, 18W, 36W only)

⑤ Wattage

Z9=9W (For 2ft single tube only)
A8=18W (For 2ft double tubes or 4ft single tube only)
C6=36 W (For 4ft double tubes only)
A0=10W (For 2ft single tube only)
B0=20W (For 2ft double tubes or 4ft single tube only)
D0=40 W (For 4ft double tubes only)