

Operating Instructions

Universal Explosion Proof LED Lighting

Model L1319



Drawing No: Instructions_L1319_IECEX

Revision Level: 01

Date: 2016-10-28

Top Hi-Tech Co., Ltd.
5F., No. 113, Zhongcheng Rd.,
Tucheng District,
New Taipei City, 236 Taiwan
Website: www.tht-ex.com

TEL: +886 2 22689570
FAX: +886 2 22689571
e-mail: sales@tht-ex.com
Revision: EX-L1319-01
Subject to alterations.

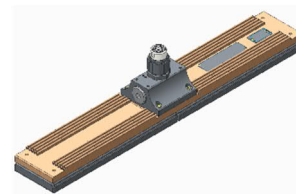

Contents

1. General Safety Instructions	1
2. Intended Field of Application	1
3. Technical Data	2
4. Model Code	2
5. Dimension	3
6. Assembly and Installation	3
7. Maintenance	5
8. Accessories and Spare Parts	5
9. Transport, Storage and Disposal	5

1. General Safety Instructions

WARNING

This manual contains basic safety instructions to be observed during installation, operation and maintenance of the apparatus, and for properly and safety run of the apparatus according to its performance data. Any damage of the apparatus may result explosion protection null and void. This manual represents the most relevant information about the product, applicable codes and regulations shall supplement it. Non-observance will endanger persons, plant and the environment. The person in charge is required to secure its employment in the industrial unit. Any improper usage, as well as non-compliance with the rules under this manual, shall release the manufacturer's all responsibilities.

The flameproof joints are not intended to be disassembled or repaired.

WARNING – The luminaire shall not be opened

1.1 Before assembly/commissioning:

- ☞ Read through the operating instructions.
- ☞ Give adequate training to the assembly and operating personnel.
- ☞ Ensure that the contents of the operating instructions are fully understood by the personnel in charge.
- ☞ The national installation and assembly regulations (e.g. IEC/EN 60079-14) apply.

1.2 When operating the device:

- ☞ Ensure the operating instructions are made available for the person in charge on location at all times.
- ☞ Observe these instructions, other working instructions and national safety regulations.
- ☞ Verify the implementation of safety instructions.



2. Intended Field of Application

The Universal Explosion Proof LED Lighting, Model L1319 is intended for using in gas explosive atmospheres (Zone 1 and Zone 2 according to IEC60079-10-1) and dust explosion hazards (Zone 21 and Zone 22 according to IEC60079-10-2). The use in other potentially explosive atmospheres does not correspond to

the designated use and is therefore not allowed.

The apparatus is designed for using in indoor and outdoor environments.

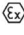
3. Technical Data

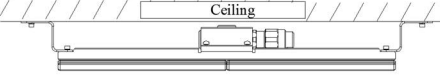
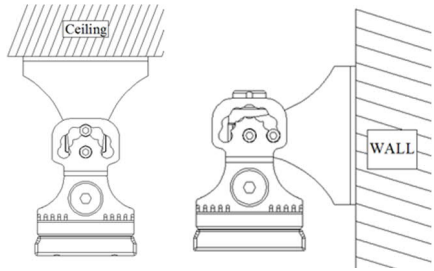
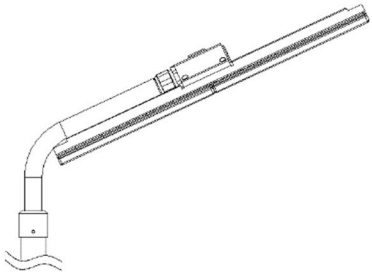
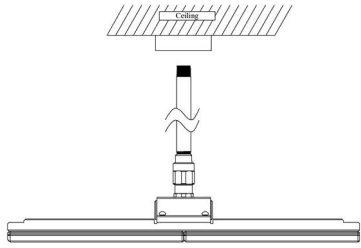
Item	Description	
Explosion Protection IECEX Gas Explosion Protection Dust Explosion Protection ATEX Gas Explosion Protection Dust Explosion Protection	Ex db IIC T6 Gb Ex tb IIIC T85°C Db  II 2 G Ex db IIC T6 Gb  II 2 D Ex tb IIIC T85°C Db	
Rated Voltage	120 Vac/220 Vac/277 Vac ($\pm 10\%$), 50 & 60 Hz; Note information on type label.	
Power Factor	≥ 0.9	
Ambient Temperate Range	$-40^{\circ}\text{C} \sim +55^{\circ}\text{C}$	
Degree of Protection	IP67	
Material	Enclosure: Aluminum alloy Glass: Tempered glass	
LED Service Life	60,000 hrs	
Entrance Hole	3×M25 threaded holes	
Cable Gland	M25×1.5 mm, Secure to Top Cover with torque value 65 N-m.	
Fitting Cable	Size of Sealing Ring	Fitting Cable
	ID: Ø8.5, Ø9.0, L=15 mm	OD: Ø7.5~ Ø9
Mounting Type / Weight (Net Lighting Weight: 7.4 kg)	Ceiling mounting	Wall & Hanging mounting
		
	7.73 kg	7.96 kg
	Stanchion mounting 25°	Pendant mounting
		
	8.84 kg	7.83 kg

4. Model Code

THT	E	1319	Z	C	C	C	2	D0	-S25
(1)	(2)	(3)	(4)	(5)	(6)	(7)	(8)	(9)	(10)

(1) Brand name, THT = Top Hi-Tech Co., Ltd

(2) Category of product, E = Explosion proof lighting fixtures

- (3) Model name, 1319 = Model L1319 series
- (4) Sub-series designation , Z = No sub-series under this model
- (5) Designates type of Top Cover, C = Top Cover with opening
- (6) Designates type of LED module, C = LED bar
- (7) Designates C.C.T of LED, C = Cool white, W = Warm white
- (8) Designates voltage, 2 = 220 Vac, 1 = 110 Vac
- (9) Designates wattage of LED lighting, D0 = 40W
- (10) Mounting type, W90 = Wall mounting
 - H90 = Hanging mounting
 - C90 = Ceiling mounting
 - S25 = Stanchion mounting 25°
 - P90 = Pendant mounting

5. Dimensions (All Dimensions in mm) – Subject to Alterations

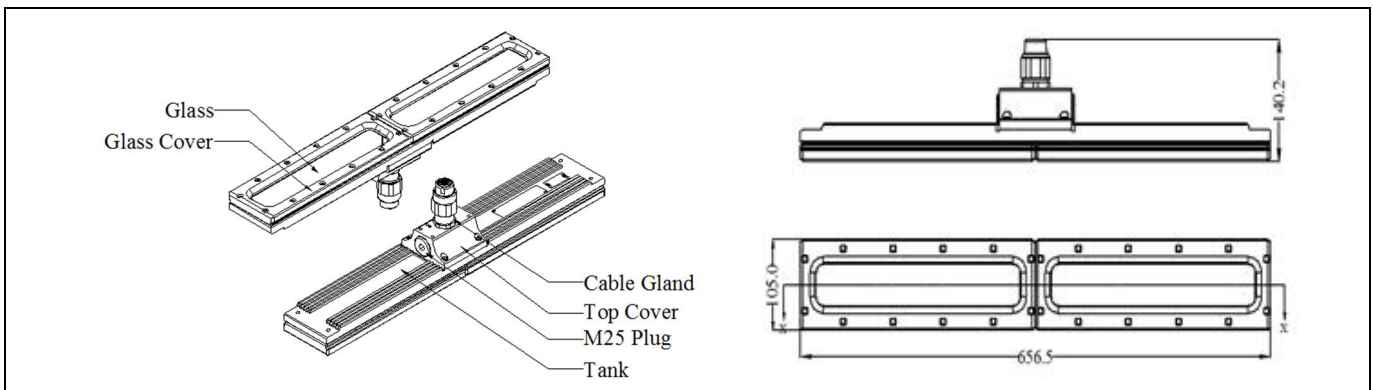

6. Assembly and Installation

6.1 Electrical Connection

Overview

1: Junction Box (Provide by customer)	2: Cable (Length(min):1.5 m)	3: L1319 Lighting
--	------------------------------	-------------------

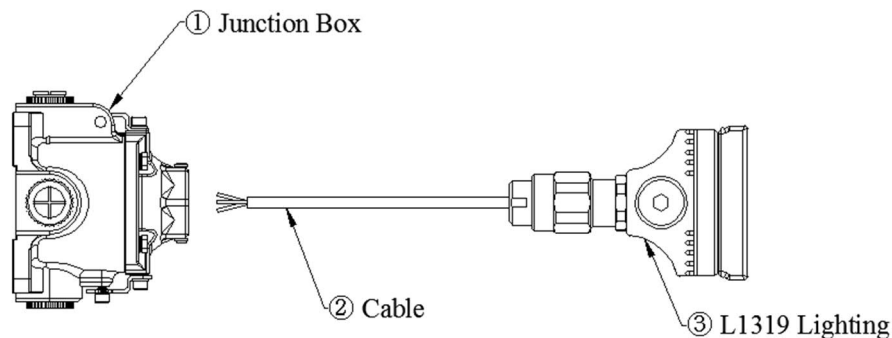

Electrical Connection

1. Insert the cable (2) of the luminary into the Ex certified Junction Box (1).
2. Fix and Introduce the wires of luminary with the terminal post of Junction Box (White-wire connects to Neutral; Red-wire connects to Live; Green-wire connects to Ground.)

Attention:

1. The Junction Box must be pass the Ex db/Ex tb certification that approved by IECEX/ATEX.
2. The minimum diameter of suitable cable for cable gland is 7.5 mm.
3. The cable types are: SJTW or SOOW, 18/3C AWG, 1 m length.

6.2 Mounting Bracket Installation

6.2.1 Wall & Hanging Mount Bracket

- ☞ The mount bracket is for the use of both Wall mount (Figure 1) and Hanging mount (Figure 2).
- ☞ Position the bracket holders and fix it by means of the provided M8 screws, 61 kgf-cm.
- ☞ Secure the Wall/Hanging mounting bracket to the structure by using four fasteners (not provided).
- ☞ The angle of lighting fixture can be adjusted.

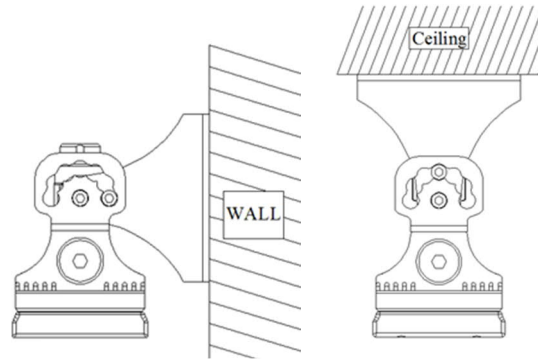

Figure 1

Figure 2

6.2.2 Ceiling Mount

- ☞ The mounting bracket is for the use of Ceiling mounting.
- ☞ Position the bracket holders and fix it by means of the provided M6 screws, 24.5 kgf-cm. (Figure 3)
- ☞ Secure the wall mounting bracket to the structure by using four fasteners (not provided).

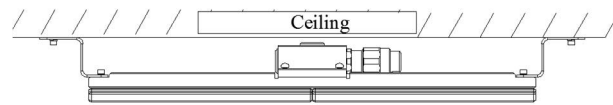

Figure 3

6.2.3 Pendant mounting

- ☞ The mounting type is for the use of bending tube mounting (Figure 4).
- ☞ Tube mounting thread is NPT 3/4".
- ☞ Thread the tube mounting on conduit and torque until wrench-tight as requirement, 2700 kgf-cm.

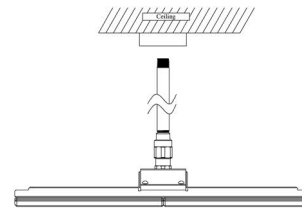

Figure 4

6.2.4 Stanchion mounting 25°

- ☞ The mounting types are for the use of bending tube mounting (Figure 5). Tube mounting thread is NPT 1-1/2"
- ☞ Thread the tube mounting on conduit and torque until wrench-tight as requirement, 6600 kgf-cm.

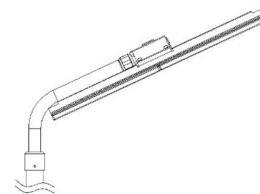
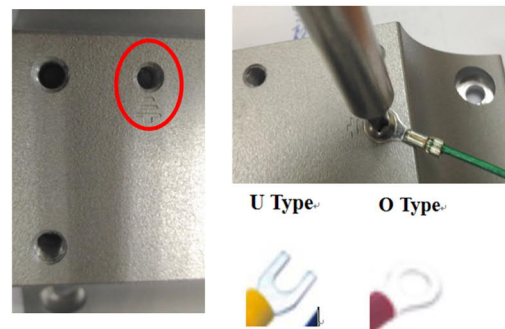

Figure 5

6.3 Ground wire

- ☞ External earth screw location as showing in the Red Circle of right pictures.
- ☞ The external earth ground wire installation and terminal type as show the right pictures.
- ☞ Ground wire cross-sectional area=4mm² , max LED current=1A; @V=110Vac-10%.
- ☞ Both ground screw and washer material is stainless steel.
- ☞ Screw hole spec: M5.
- ☞ Torque requirement: 14.5 kgf.cm.
- ☞ Ensure wire is tied assured.



6.4 Putting into Service

Before putting into operating, it's necessary to ensure that:

- ☞ the lighting is correctly installed.
- ☞ the connection has been correctly made.
- ☞ the cable has been inserted correctly.
- ☞ the voltage is correctly

7. Maintenance

WARNING

- ▶ To avoid dangers due to energized parts, all connections and wiring must be disconnected from the power supply. Secure the connections against unauthorized activation.
- ▶ To avoid risk of burn to hands, let the housing, the cable gland and the protective glass cool down for approximate 30 minutes before touching them.
- ▶ Maintenance work is not permitted on flameproof enclosures. Repairs are only to be carried out by the manufacturer. Unauthorized repair shall cause the manufacturer's liability and warranty expires.

Regular Maintenance

- ☞ Consult the relevant national regulations (e.g. IEC/EN 60079-17) to determine the type and extent of inspections.
- ☞ Arrange the plan of regular inspection with the equipment, one time per 3-month at least, so that any defects in the equipment which may be anticipated are promptly detected.

To check as part of the maintenance schedule as following:

- ☞ Cracks or damages on the glass cover and/or on the enclosure.
- ☞ Condition of the connecting cables.
- ☞ Screws of the mounting bracket are tightened.

8. Accessories and Spare Parts

WARNING

Use only original THT-EX accessories and spare parts. For accessories and spare parts, see data sheet at www.tht-ex.com.

9. Transport, Storage and Disposal

- ☞ Transport and storage is only allowed in the original packaging, on the way pointed out on the carton box.
- ☞ Transport – Shock-free in its original carton, do not drop, and handle carefully.
- ☞ Store – Store in a dry place in its original packaging.
- ☞ Disposal – Ensure environmentally friendly disposal of all components according to the legal regulations.