

# L1733NS Hazardous Location LED Lighting



Optional: Sensing Device  
(Daylight or Occupancy Sensor)

**CID2**  
Group  
A, B, C, D

**IP67**

**NEMA**  
6

## Protection

- Class I, Division 2,  
Groups A, B, C, D

## Standards

UL 844  
UL 1598 Luminaires  
UL 8750  
CSA C22.2 No. 137-18  
CSA C22.2 No. 250.0  
CSA C22.2 No. 250.13

Net Weight: 11.7 kg (25.8 lb)

## Technical Data

| Rated Voltage (±10%)            | Watts (±10%)      | Ambient Temperature |
|---------------------------------|-------------------|---------------------|
| 110 / 120 / 220 / 230 / 277V AC | 180W              | -20°C~+40°C / T3    |
| 110 / 120 / 220 / 277V AC       | 140W / 160W       | -20°C~+45°C / T3    |
|                                 | 80W / 100W / 120W | -20°C~+50°C / T3    |
|                                 | 60W               | -20°C~+75°C / T4    |

|                      |  |
|----------------------|--|
| Amps                 | 0.22A~1.64A  |
| Color of LED Light   | 3000K (Warm White) / 5000K (Cool White)  |
| Power Factor         | cos≥0.9  |
| CRI                  | Cool White≥70 / Warm White≥80  |
| Lumen (±10%)         | Cool White≥120 lm / Warm White≥110 lm  |
| Frequency            | 50 / 60 Hz   |
| Degree of Protection | IP67 / NEMA 6  |
| Material             | <ul style="list-style-type: none"> <li>Enclosure: Aluminum alloy</li> <li>Glass: Tempered glass</li> </ul> |
| LED Service Life     | 60,000 hrs   |
| Entrance Thread      | 1 × NPT 3/4"   |

### Daylight Sensor: Digital data control ambient light sensor

|               |                                  |
|---------------|----------------------------------|
| Sensing Range | Approx. 2~2,000 lux (0.2~200 fc) |
| Field of View | Approximate 80°                  |

### Occupancy Sensor: Detection Pattern

|                 |                    |                    |
|-----------------|--------------------|--------------------|
| Mounting Height | 3 m (10 ft)        | 6 m (20 ft)        |
| Coverage*       | 180 m² (2,000 ft²) | 100 m² (1,200 ft²) |

\*Sensitivity 100%

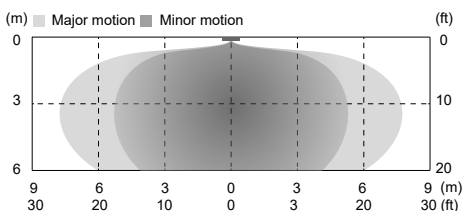

## Optical Report

COB test

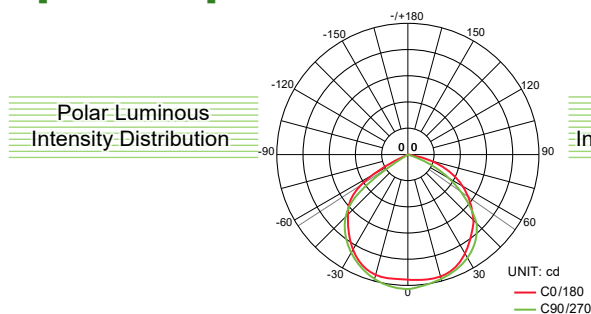

COB test

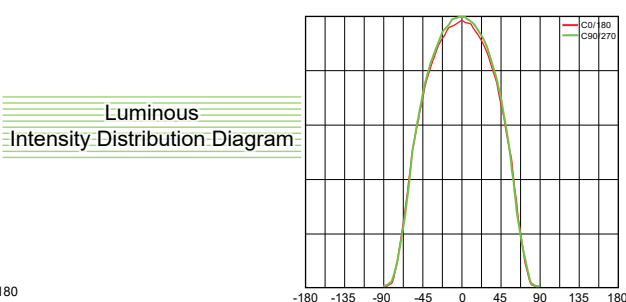

## Model Code

|            |          |              |          |          |          |          |           |           |            |
|------------|----------|--------------|----------|----------|----------|----------|-----------|-----------|------------|
| <b>THT</b> | <b>H</b> | <b>1733S</b> | <b>S</b> | <b>B</b> | <b>C</b> | <b>9</b> | <b>S0</b> | <b>01</b> | <b>WHT</b> |
|            |          |              | ①        |          | ②        | ③        | ④         |           | ⑤          |

### ① Sensor

S =With Sensor  
Z =Without Sensor

### ② C.C.T.

C =Cool White  
W =Warm White

### ③ Voltage

1=110V, 2=220V,  
6=120V, 9=277V,  
D=230V

### ④ Wattage

F0=60W, H0=80W, J0=100W,  
L0=120W, N0=140W, Q0=160W,  
S0=180W

### ⑤ Mounting Bracket Type

WHT(W90)=Wall Mount 90°  
WHT(H90)=Hanging Mount 90°  
RO=Rotatable  
SL=Street Light



## Mounting Option & Dimensions (All in mm)

Wall Mount 90° [WHT(W90)]

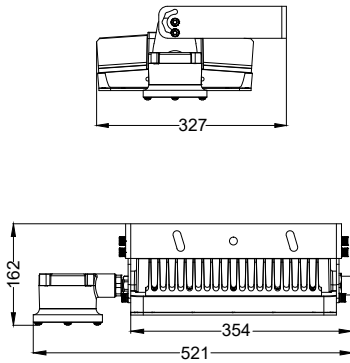

14.2 kg (31.3 lb)

Street Light (SL)

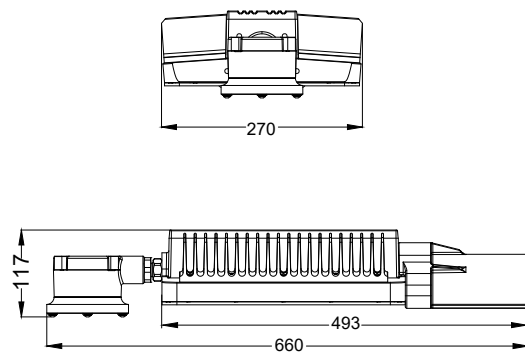

14.1 kg (31.1 lb)

Rotatable (RO)

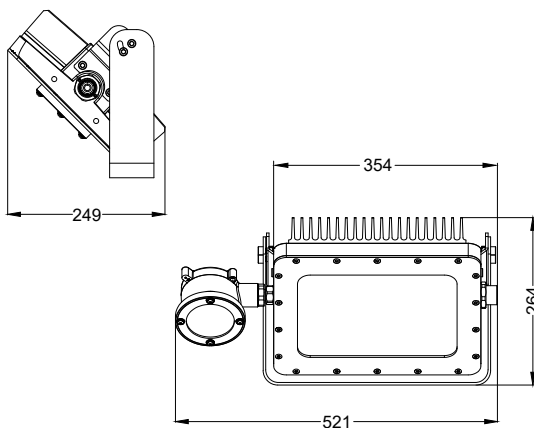

14.2 kg (31.3 lb)

Hanging Mount 90° [WHT(H90)]

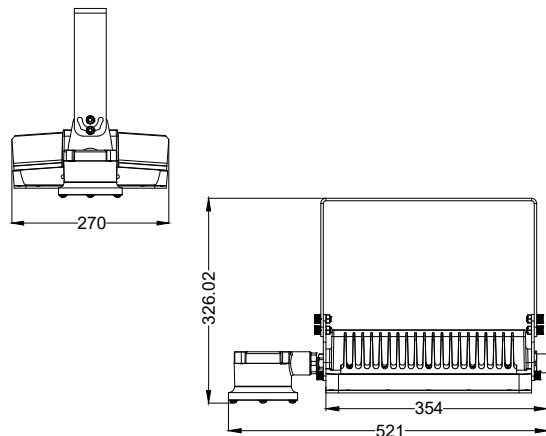

14.2 kg (31.3 lb)