

L1733NS Hazardous Location LED Lighting

Optional: Sensing Device
(Daylight or Occupancy Sensor)



CID2
Group
A, B, C, D

IP67

NEMA
6

Protection

- Class I, Division 2, Groups A, B, C, D

Standards

UL 844
UL 1598 Luminaires
UL 8750
CSA C22.2 No. 137-18
CSA C22.2 No. 250.0
CSA C22.2 No. 250.13

Net Weight: 12.9kg (28.4 lb)

Lens Angle

30°, 60°, 90°, 150°, 15°x155°,
60°x145°, 70°x140°, 85°x150°,
150°x50°, 65°x145°, 65°x150°

Technical Data

Rated Voltage (±10%)	100~277AC(Full Volt.)
Watts (±10%)	70W / 105W
Ambient Temperature	-20°C ~ +55°C ,T3C(70W) / -20°C ~ +45°C ,T3A (105W)
Amps	0.25A~1.05A
Color of LED Light	3000K (Warm White) / 5000K (Cool White)
Power Factor	cos≥0.9
CRI	Cool White≥70 / Warm White≥80
Lumen (±10%)	≥ 135 lm
Frequency	50 / 60 Hz
Degree of Protection	IP67 / NEMA 6
Material	<ul style="list-style-type: none"> Enclosure: Aluminum alloy Glass: Tempered glass
LED Service Life	60,000 hrs
Entrance Thread	1 × NPT 3/4"

Daylight Sensor: Digital data control ambient light sensor

Sensing Range	Approx. 2~2,000 lux (0.2~200 fc)
Field of View	Approximate 80°

Occupancy Sensor: Detection Pattern

Mounting Height	3 m (10 ft)	6 m (20 ft)
Coverage*	180 m² (2,000 ft²)	100 m² (1,200 ft²)

*Sensitivity 100%

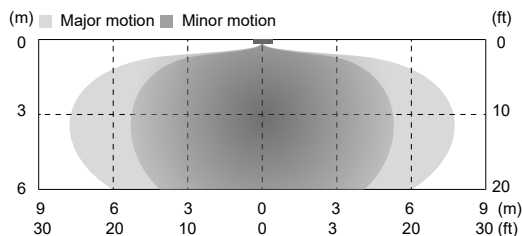

Optical Report

LED Lens 60°x145°
(NEMA 6x7)

Polar Luminous
Intensity Distribution

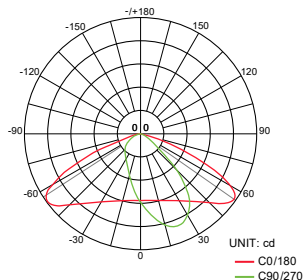

Luminous
Intensity Distribution Diagram

LED Lens 60°x145°
(NEMA 6x7)

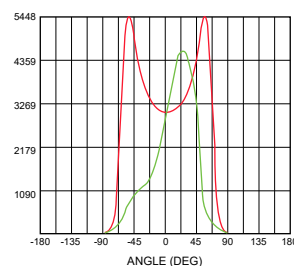

*There are different luminous distributions according to the angle of lens, please contact us for details.

Model Code

THT	H	1733S	S	K	C	H	J5	01	WHT
			①		②		③		④

① Sensor

S =With Sensor
Z =Without Sensor

③ Wattage

G0=70W, J5=105W

② C.C.T.

C =Cool White
W=Warm White

④ Mounting Bracket Type

WHT(W90)=Wall Mount 90°
WHT(H90)=Hanging Mount 90°
RO=Rotatable
SL=Street Light



Mounting Option & Dimensions (All in mm)

Wall Mount 90° [WHT(W90)]

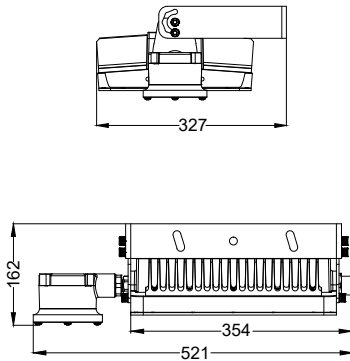

14.2 kg (31.3 lb)

Street Light (SL)

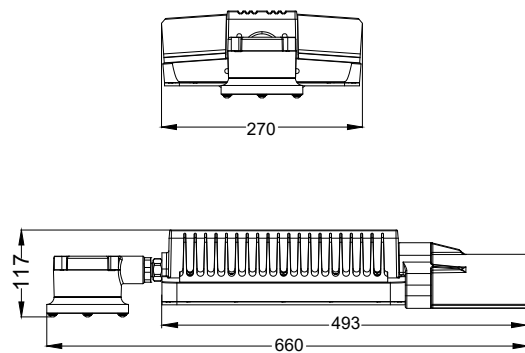

14.1 kg (31.1 lb)

Rotatable (RO)

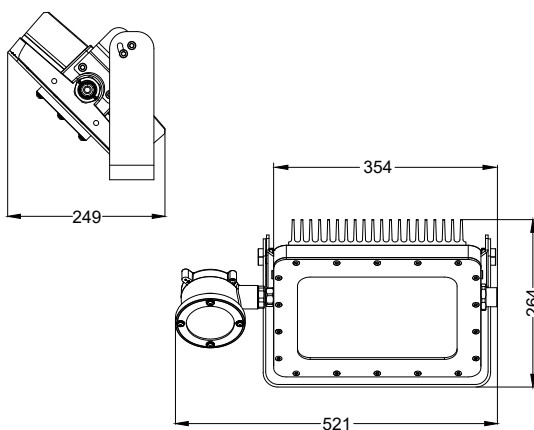

14.2 kg (31.3 lb)

Hanging Mount 90° [WHT(H90)]

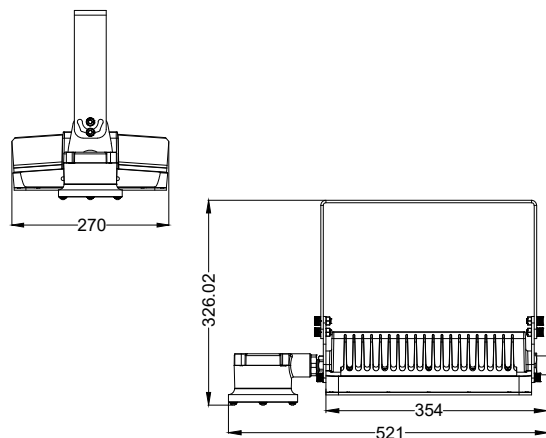

14.2 kg (31.3 lb)