

L1733NS Hazardous Location LED Lighting

Optional: Sensing Device
(Daylight or Occupancy Sensor)

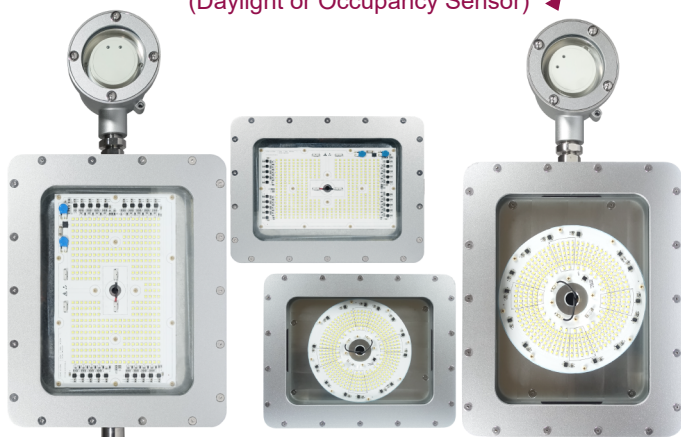

CID2
Group
A, B, C, D

IP67

NEMA
6

Protection

- Class I, Division 2,
Groups A, B, C, D

Standards

UL 844
UL 1598 Luminaires
UL 8750
CSA C22.2 No. 137-18
CSA C22.2 No. 250.0
CSA C22.2 No. 250.13

Net Weight: 13.0 kg (28.7 lb)

Technical Data

Rated Voltage (±10%)	110 / 120 / 220 / 230 / 277V AC
Watts (±10%)	120W / 140W / 150W / 170W / 200W
Ambient Temperature	-20°C ~ +55°C ,T4
Amps	0.43A~1.82A
Color of LED Light	3000K (Warm White) / 5000K (Cool White)
Power Factor	cos≥0.9
CRI	Cool White≥70 / Warm White≥80
Lumen (±10%)	≥ 120 lm
Frequency	50 / 60 Hz
Degree of Protection	IP67 / NEMA 6
Material	<ul style="list-style-type: none"> Enclosure: Aluminum alloy Glass: Tempered glass
LED Service Life	60,000 hrs
Entrance Thread	1 × NPT 3/4"

Daylight Sensor: Digital data control ambient light sensor

Sensing Range	Approx. 2~2,000 lux (0.2~200 fc)
Field of View	Approximate 80°

Occupancy Sensor: Detection Pattern

Mounting Height	3 m (10 ft)	6 m (20 ft)
Coverage*	180 m ² (2,000 ft ²)	100 m ² (1,200 ft ²)

*Sensitivity 100%

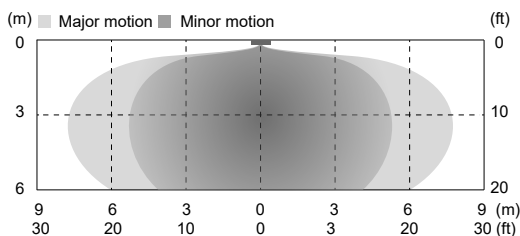

Optical Report

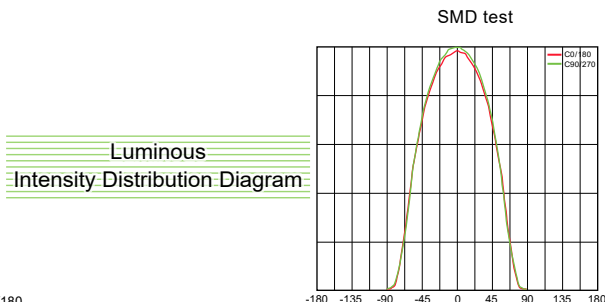
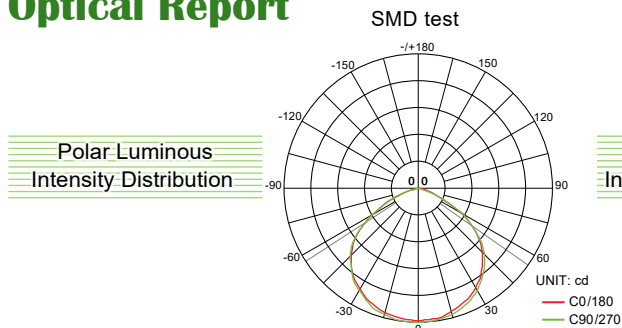

Model Code

THT	H	1733S	S	K	C	9	U0	01	WHT
			①		②	③	④		⑤

① Sensor

S =With Sensor
Z =Without Sensor

③ Voltage

1=110V, 2=220V, 6=120V,
9=277V, D=230V

⑤ Mounting Bracket Type

WHT(W90)=Wall Mount 90°
WHT(H90)=Hanging Mount 90°
RO=Rotatable
SL=Street Light

② C.C.T.

C=Cool White
W=Warm White

④ Wattage

L0=120W, N0=140W, P0=150W,
R0=170W, U0=200W



Mounting Option & Dimensions (All in mm)

Wall Mount 90° [WHT(W90)]

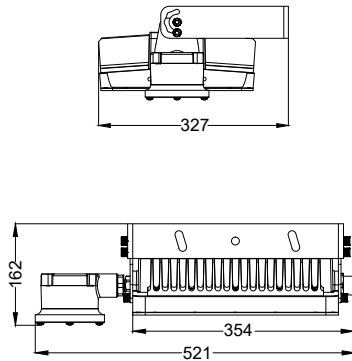

14.2 kg (31.3 lb)

Street Light (SL)

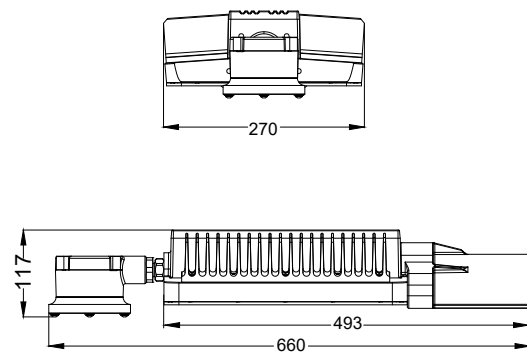

14.1 kg (31.1 lb)

Rotatable (RO)

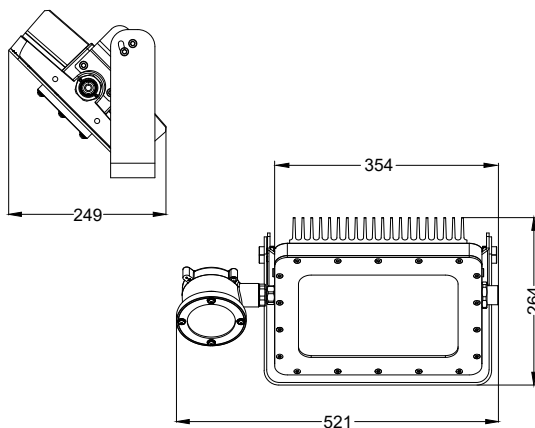

14.2 kg (31.3 lb)

Hanging Mount 90° [WHT(H90)]

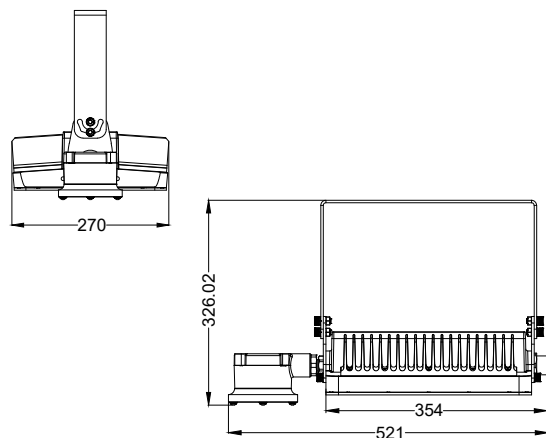

14.2 kg (31.3 lb)