

S1912A/B Explosion-proof Sensor



1 Hub



2 Hub

Zone
2

Zone
21

Zone
22

IP67

NEMA
6

Protection

- Ex nR IIC T6 Gc
- Ex tb IIIC T80°C Db
- Ex II 3 G Ex nR IIC T6 Gc
- Ex II 2 D Ex tb IIIC T80°C Db

Standards

IEC 60079-0
IEC 60079-15
IEC 60079-31
EN IEC 60079-0
EN IEC 60079-15
EN 60079-31

Net Weight:

1 Hub: 1.05kg (2.31lb) / 2 Hub: 1.18kg (2.60lb)

Technical Data

Series	THTS1912AxSZH00 (S1912A)	THTS1912BxSZH00 (S1912B)							
Feature	<p>Daylight Sensor</p> <p>This sensor is able to continuously measure the ambient light level in the controlled area and respond with switched line voltage output to control the connected lighting accordingly.</p>	<p>Occupancy Sensor</p> <p>This occupancy sensor employs an advanced High Frequency Doppler (HFD) sensing technology to provide superior sensing performance of minor motions. The HFD technology is operating with high frequency radio waves which are capable of detecting the occupant's presence and movements without requiring unobstructed line-of-sight like PIR sensor.</p>							
Power Supply	100~277VAC, 50/60Hz	100~277VAC, 50/60Hz							
Maximum Load	@-40°C~55°C Incandescent / Halogen - 800 / 1200W(VA) Fluorescent Ballast / CFL - 800 / 1200W(VA) Ballast Electronic (LED) - 540 / 1200W(VA)	*@-40°C~55°C **@55°C~70°C	100/120V AC	240V AC	277V AC				
		Incandescent Halogen	800W(VA)* 500W(VA)**	5A	1200W(VA)* 750W(VA)**				
	@55°C~70°C Incandescent / Halogen - 500 / 750W(VA) Fluorescent Ballast / CFL - 500 / 750W(VA) Ballast Electronic (LED) - 500 / 750W(VA)	Fluorescent Ballast CFL	800W(VA)* 500W(VA)**	5A	1200W(VA)* 750W(VA)**				
		Ballast Electronic (LED)	540W(VA)* 500W(VA)**	5A	1200W(VA)* 750W(VA)**				
Description*	<p>Digital Data Control Ambient Light Sensor</p> <table><tr><td>Sensing Range</td><td>Approx. 2~2,000 lux (0.2~200 fc)</td></tr><tr><td>Field of View</td><td>Approximate 80°</td></tr></table> <p>Detection Pattern</p> <p>Mounting Height</p> <p>Sensitivity 100% 75% 50%</p>					Sensing Range	Approx. 2~2,000 lux (0.2~200 fc)	Field of View	Approximate 80°
Sensing Range	Approx. 2~2,000 lux (0.2~200 fc)								
Field of View	Approximate 80°								

*The sensing data without enclosure is for reference only.

Model Code

THT

S

1912

A

J

S

Z

H

00

①

②

① Function

A=Daylight Sensor

B=Occupancy Sensor

② Appearance Type

J=1 Hub

K=2 Hub

Mounting Option & Dimensions (All in mm)

1 Hub

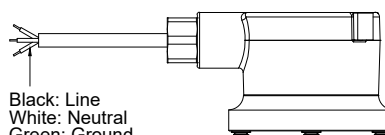
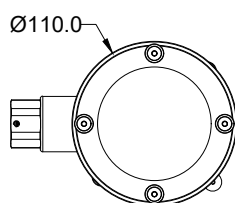
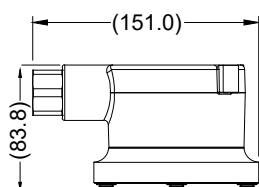

Black: Line
White: Neutral
Green: Ground
Red: Line (Load)**
Yellow: Neutral (Load)**

**Load: To equipment ,Ex:Luminaire...

2 Hub

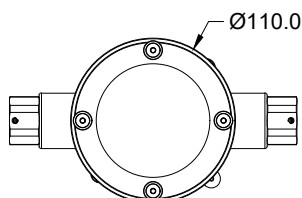
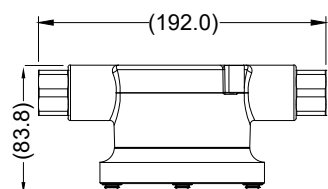

Black: Line
White: Neutral
Green: Ground

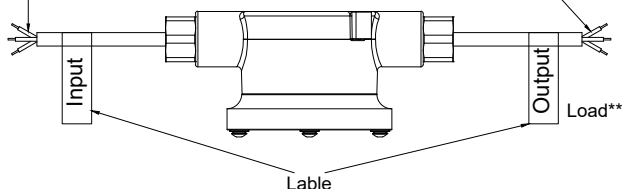

**Load: To equipment ,Ex:Luminaire...

Ceiling Mount

