

L1905

Net Weight: 5 kg (11 lb)

Clear PC Cover

Matte PC Cover



Red



Green



High Humidity & Heat Resistant LED Light

- ★ AC LED Driver-less Technology
- ★ Intended for Use in High Ambient Temperature Environments

High Ambient Temperature:

+66°C ~ +85°C (+150.8°F ~ +185°F)

Standards

UL 844 / UL 1598

UL 8750 / CSA C22.2 No.250.0

IEC 60079 / EN 60079

Applications:

- Pulp & Paper (Cooking and Drying Area)
- Glass Factory (Processing Area)
- Metal Forging or Metal Recycling Plant (Heating or Forging Area)
- Oil & Gas (Furnace Towers or Compressor Rooms)
- Garbage Processing Plant (Burning Area)
- Coal Power Plant (Burning Area)
- Gas Turbine Power Plant (Gas Turbine Area)
- Painting Factory (Drying Area)
- Winery (Distillation Chamber)
- Textile (Dyeing and Finishing Area)
- Food Process (Heating, Cooking or Baking Area)

Waterproof:

IP67

Dimension:

In mm (inches)

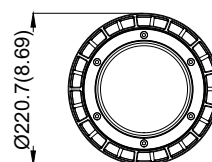
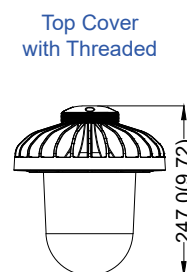
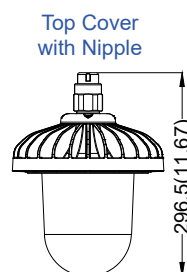

Electrical:

85°C / 185°F Heat Resistant

COB	100V	110V	120V	200V	208V	220V	240V	277V
20W	0.20A	0.18A	0.17A	0.10A	0.10A	0.09A	0.08A	0.07A
20W-Red			0.17A			0.09A		0.07A
20W-Green			0.17A					0.07A

85°C / 185°F Heat Resistant

SMD	110V	120V	220V	230V	277V
40W	0.36A	0.33A	0.18A	0.17A	0.14A
50W	0.45A	0.42A	0.23A	0.22A	0.18A
60W	0.55A	0.50A	0.27A	0.26A	0.22A
50W-Red			0.23A		

Power Factor	$\cos \geq 0.9$			
Frequency	50 / 60 Hz			
LED Service Life	60,000 hrs*			
Warranty	2 years warranty without warranting lumen depreciation.			

*L70 at 55°C Ambient Temperature

Mechanical:

Enclosure	Aluminum Alloy
PC Cover	Clear / Matte PC Cover
Cable Gland	Stainless Steel
Cable	600V, 105°C

Optical:

Color of LED Light	3000K (Warm White) / 5000K (Cool White) / Red / Green		
CRI	Warm White ≥ 80 / Cool White ≥ 70		
Beam Angle	Clear X-127°, Y-127° / Matte X-177°, Y-177°		
Lm / W ($\pm 10\%$)	Warm White $\geq 90\text{lm}$ / Cool White $\geq 100\text{lm}$		

[Total Lumen = Watt. \times (Lm/W)]

Optical Report:

SMD test (Clear PC Cover)

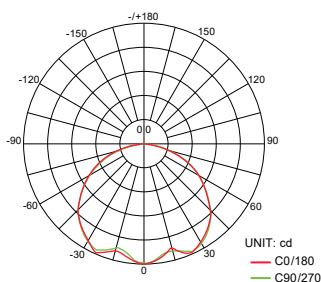
Polar Luminous
Intensity DistributionLuminous
Intensity Distribution Diagram

AVERAGE BEAM ANGLE (50%) : 126.7 DEG

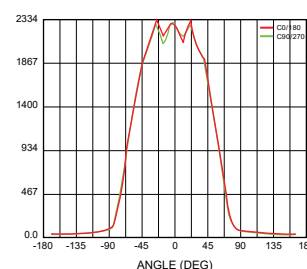

Mounting Option & Dimension : In mm (inches)

Top Cover with Threaded

Wall Mount 6.2 kg (13.7 lb)

(W)

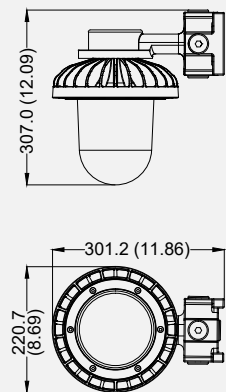

Hanging Mount 6.2 kg (13.7 lb)

(H)

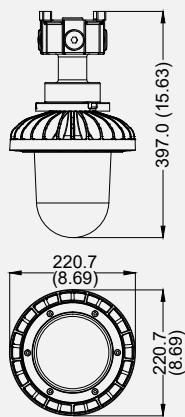

Stanchion Mount 5.8 kg (12.8 lb)

(S)

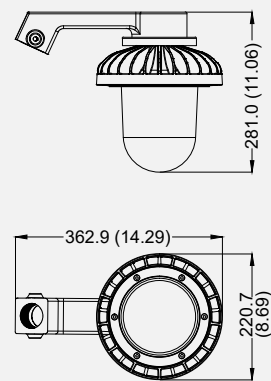

Top Cover with Nipple

Stanchion Mount 25°

(S25)

5.3 kg (11.7 lb)

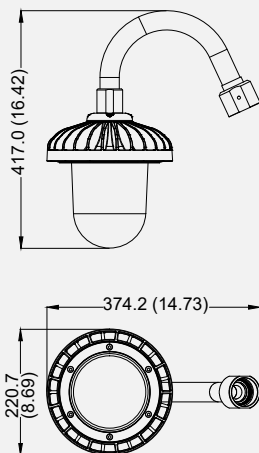

Stanchion Mount 90°

(S90)

5.4 kg (11.9 lb)

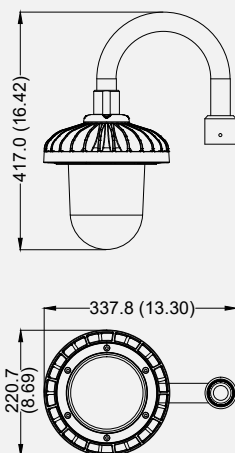

Pendant Mount

(P)

4.6 kg (10.1 lb)

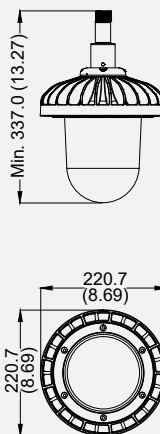

Ceiling Mount

(C)

6.2 kg (13.7 lb)

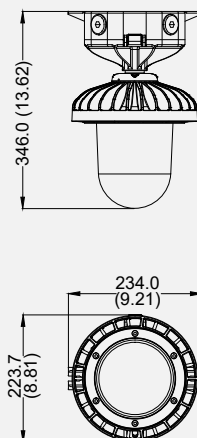

With Optional Accessory “Guard” : In mm (inches)

Top Cover with Threaded

Wall Mount 6.4 kg (14.1 lb)

(W)

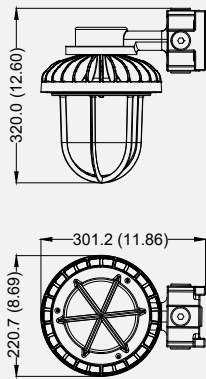

Hanging Mount 6.4 kg (14.1 lb)

(H)

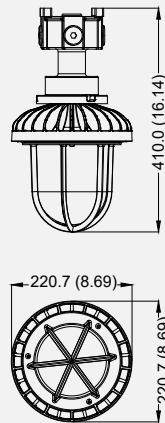

Stanchion Mount 6.0 kg (13.2 lb)

(S)

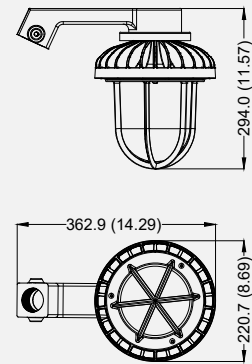

Top Cover with Nipple

Stanchion Mount 25°

(S25)

5.5 kg (12.1 lb)

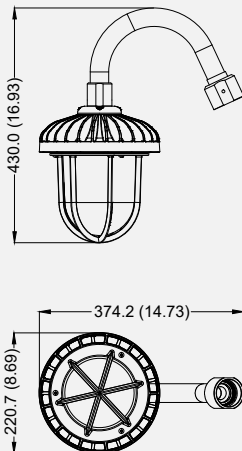

Stanchion Mount 90°

(S90)

5.6 kg (12.3 lb)

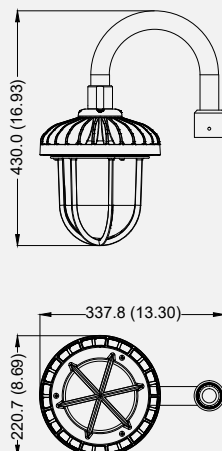

Pendant Mount

(P)

4.8 kg (10.6 lb)

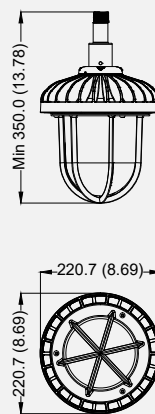

Ceiling Mount

(C)

6.4 kg (14.1 lb)

