

L2101

Luminaires For Use In Hazardous Locations

2ft-Dual Tubes



4ft-Dual Tubes

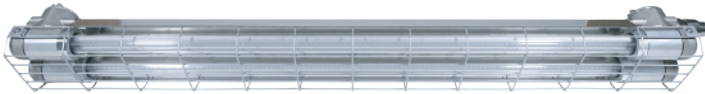

4ft-Single Tube



Protection

- Class I, Division 1 Group C, D
- Class II, Division 1 Group E, F, G
- Class III

Standards

- UL 844
- UL 1598 Luminaires
- CSA C22.2 No. 137-18
- CSA C22.2 No. 250.0

Net Weight:

2ft-Single Tube:5.0kg (11.0 lb) / 4ft-Single Tube:7.7kg (16.9 lb)
2ft-Dual Tube:7.3kg (16.1 lb) / 4ft-Dual Tube:10.4kg (22.8 lb)

4ft- Dual Yellow Tubes



Technical Data

Explosion-proof LED Tube				
Size	2ft-Single Tube	4ft-Single Tube	2ft-Dual Tubes	4ft-Dual Tubes
Watt.(±10%)	9W	18W	18W	36W
Volt.(±10%)	100V-277V AC			
Light Color	Warm White (3000K) / Natural White (4000K) / Daylight (5700K) / Cool White (6500K)			
Lm / W (±10%)	100 lm/w			

Yellow Tube Light				
Size	2ft-Single Tube	4ft-Single Tube	2ft-Dual Tubes	4ft-Dual Tubes
Watt.(±10%)	10W	20W	20W	40W
Volt.(±10%)	120V-277V AC			
Light Color	Yellow			

Amps	9W: 0.03A~0.09A, 10W: 0.04A~0.08A, 18W: 0.06A~0.18A, 20W: 0.07A~0.20A, 36W: 0.13A~0.36A, 40W: 0.14A~0.33A
Ambient Temperature	-20°C ~ +40°C, T6
Power Factor	≥0.95/100VAC, ≥0.95/110VAC, ≥0.9/120VAC, ≥0.9/220VAC, ≥0.8/277VAC
CRI	≥ 70 (Excluding Yellow Tube)
Beam Angle	X-110° / Y-110°
Frequency	50 / 60 Hz
Degree of Protection	IP67 / NEMA 6
Material	<ul style="list-style-type: none"> • Enclosure: Aluminum Alloy • Lighting Tube: Glass
LED Service Life	60,000 hrs
Entrance Thread	1 x M25

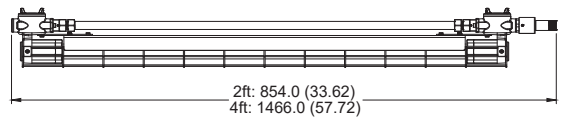

Single Tube

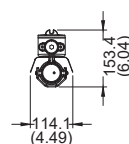

Dual Tubes

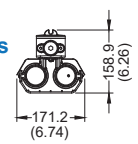

Dimension in Millimeters (inches)

Optical Report

Polar Luminous Intensity Distribution

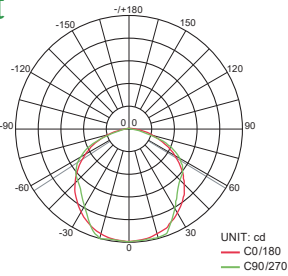

Luminous Intensity Distribution Diagram

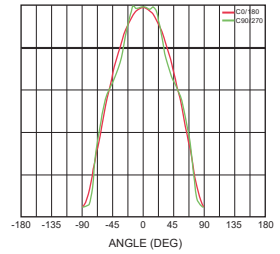

Yellow Light - Spectral Distribution

Relative Spectral

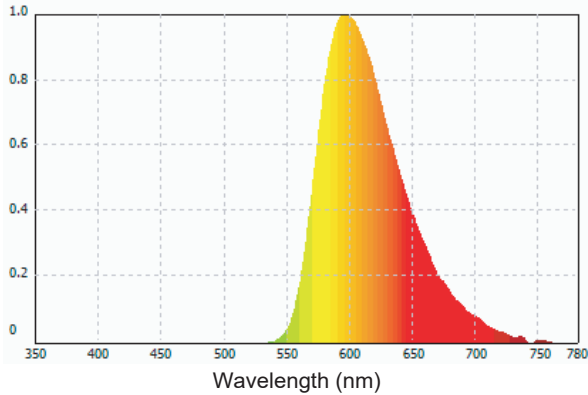

Mounting Option & Dimensions (All in mm)

Single Tube

Ceiling (C90) / Wall Mount 90° (W90)

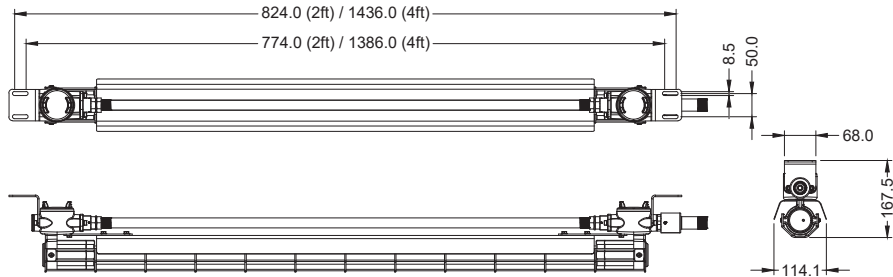

2ft-Single Tube:5.4kg (11.9 lb)
 4ft-Single Tube:8.1kg (17.9 lb)

Pendant Mount (P90)

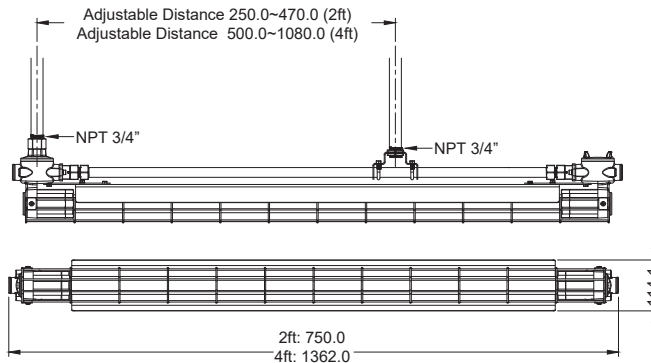

2ft-Single Tube:5.3kg (11.7 lb)
 4ft-Single Tube:8.0kg (17.6 lb)

(The pendant mount doesn't include electrical tubes, but with installation holes reserved.)

Mounting Option & Dimensions (All in mm)

Dual Tubes

Ceiling (C90) / Wall Mount 90° (W90)

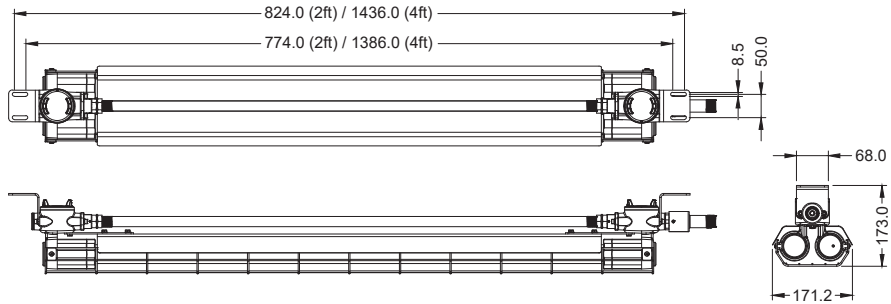

2ft-Dual Tube: 7.7kg (17.0 lb)
4ft-Dual Tube: 10.8kg (23.8 lb)

Pendant Mount (P90)

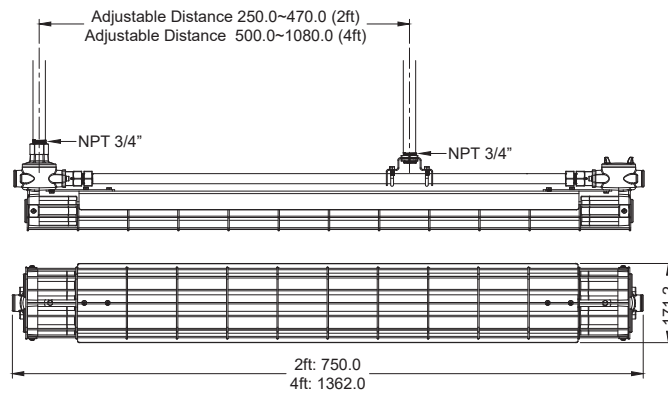

(The pendant mount doesn't include electrical tubes, but with installation holes reserved.)

2ft-Dual Tube: 7.6kg (16.8 lb)
4ft-Dual Tube: 10.7kg (23.6 lb)

Model Code

THT

E

2101

D

D

W

H

C6

C90

①

②

③

④

⑤

⑥

① Length of Luminaire

- A=2ft single tube (For 9W, 10W only)
- B=4ft single tube (For 18W, 20W only)
- C=2ft double tubes (For 18W, 20W only)
- D=4ft double tubes (For 36W, 40W only)

② Type of Top Cover

- C=Top cover with opening
- D=Top cover without opening

*Pendant Mount only with C type (top cover with opening).

③ Light Color

- W=Warm white/3000K (For 9W, 18W or 36W only)
- N=Natural white/4000K (For 9W, 18W or 36W only)
- D=Daylight/5700K (For 9W, 18W or 36W only)
- C=Cool white/6500K (For 9W, 18W or 36W only)
- Y=Yellow tube (For 10W, 20W or 40W only)

④ Voltage

- A=120-277V (For 10W, 20W, 30W)
- H=100-277V (For 9W, 18W, 36W only)

⑤ Wattage

- Z9=9W (For 2ft single tube only)
- A8=18W (For 2ft double tubes or 4ft single tube only)
- C6=36 W (For 4ft double tubes only)
- A0=10W (For 2ft single tube only)
- B0=20W (For 2ft double tubes or 4ft single tube only)
- D0=40 W (For 4ft double tubes only)

⑥ Mounting Bracket Type

- C90=Ceiling
- W90=Wall Mount 90°
- P90=Pendant